

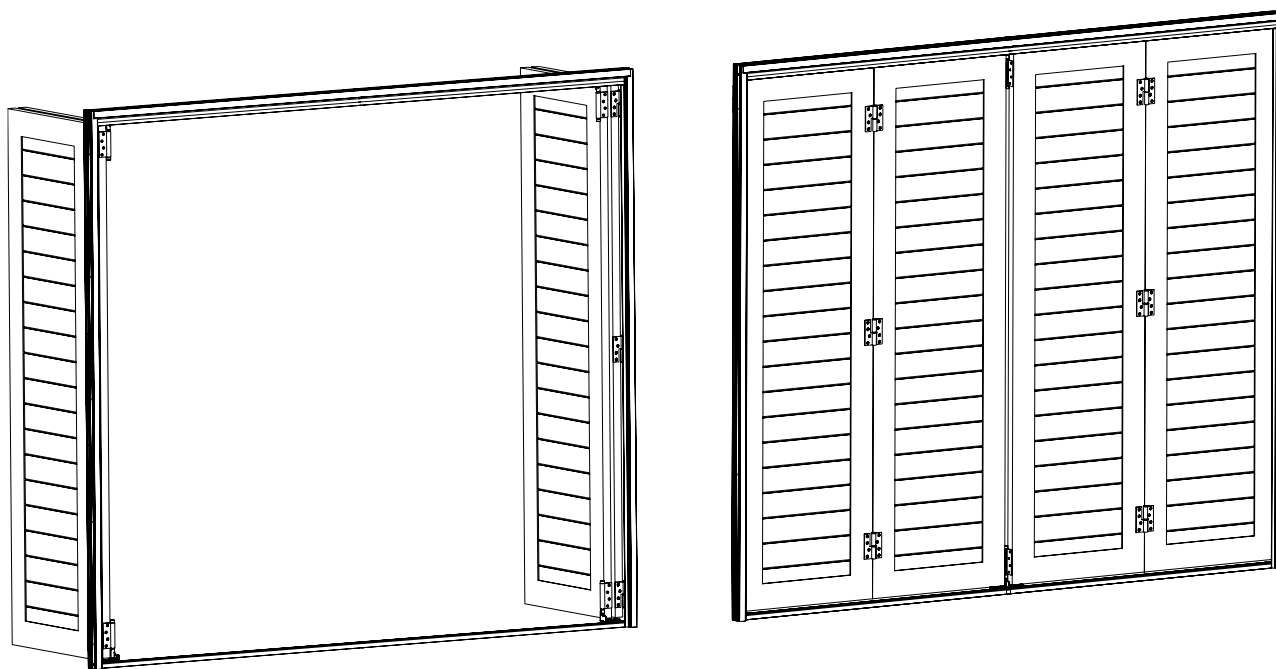

Istruzioni di posa



Vista dall'interno



Gamma VCP300

Ferramenta per persiane scorrevoli ripieghevoli
Per configurazione 2+2

Componenti

PROFILI E ACCESSORI PER TELAIO IN ALLUMINIO

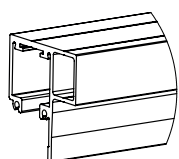

A VR10906



B VR10917

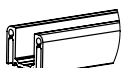

C VR10926

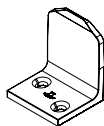

D VR10930

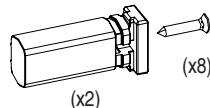

E VR10830

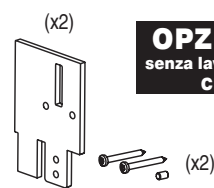

T VR10918

OPZIONE
senza lavorazione
CNC

SCORRIMENTO SUPERIORE

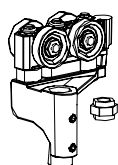

F1 VR10100G



F2 VR10200D

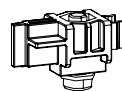

G VR10300

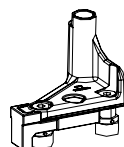

I1 VR10400G

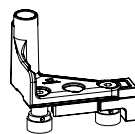

I2 VR10500D

COLLEGAMENTO PROFILI/ANTE

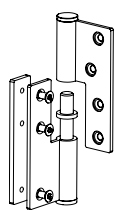

K1 VR10821G

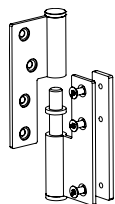

K2 VR10822D

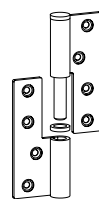

L1 VR10809G

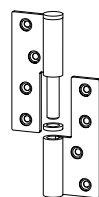

L2 VR10810D

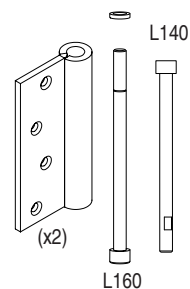

O VR10818

CHIUSURA

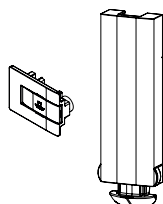

P VR10835



Q VR10837

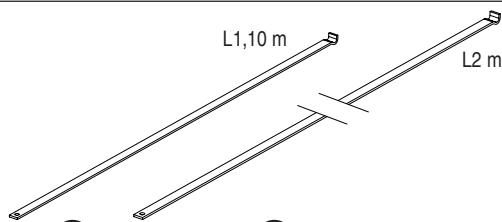

R VR10838J

S VR10839J

Descrizione		Codice	Conf.	H anta < 1800 mm	1800 <= H anta > 2800 mm	2800 <= H anta > = 3000 mm
				2+2	2+2	2+2
				Unità	UnitàUnità	UnitàUnità
PROFILI E ACCESSORI PER TELAIO IN ALLUMINIO						
A	BINARIO SUPERIORE IN ALLUMINIO 6M	VR10906	9	1	1	1
B	PROFILO TELAIO LATERALE CON BATTUTA IN ALLUMINIO 6 M	VR10917	9	1	1	1
C	GUIDA A U INFERIORE IN ALLUMINIO 6M	VR10926	9	1	1	1
D	BATTUTA INFERIORE ZAMA PER GUIDA A U INFERIORE	VR10930	1	2	2	2
E	KIT 2 BATTUTE FISSE NYLON PER GUIDA INFERIORE + VITI	VR10830	1	1	1	1
T	KIT 2 PIASTRE DI GIUNZIONE PER CONTROTELAIO OPZIONE senza lavorazione CNC	VR10918	1	1	1	1
SCORRIMENTO SUPERIORE						
F1	CARRELLO SUPERIORE ESTERNO SINISTRO VISTA INTERNA	VR10100G	1	1	1	1
F2	CARRELLO SUPERIORE ESTERNO DESTRO VISTA INTERNA	VR10200D	1	1	1	1
G	BATTUTA CARRELLO SUPERIORE NYLON	VR10300	1	2	2	2
SCORRIMENTO INFERIORE						
I1	SLITTA INFERIORE TERMINALE SINISTRA VISTA INTERNA	VR10400G	1	1	1	1
I2	SLITTA INFERIORE TERMINALE DESTRA VISTA INTERNA	VR10500D	1	1	1	1
COLLEGAMENTO PROFILI/ANTE						
K1	POMELLA PER TELAIO DESTRA VISTA INTERNA	VR10821G	1	2	3	4
K2	POMELLA PER TELAIO SINISTRA VISTA INTERNA	VR10822D	1	2	3	4
L1	POMELLA CENTRALE PIATTA SINISTRA	VR10809G	1	2	3	4
L2	POMELLA CENTRALE PIATTA DESTRA	VR10810D	1	2	3	4
O	2 MEZZE POMELLE TERMINALI + VITI	VR10818	1	2	2	2
P	KIT CHIAVISTELLO PIATTO + GUIDA ASTA NYLON NERO	VR10835	10	4	4	4
Q	GUIDA ASTA + MANIGLIETTA ERGONOMICA NYLON NERO	VR10837	10		4	4
R	ASTA ALLUMINIO 1,10M PER CHIAVISTELLO PIATTO	VR10838J	10	4	4	2
S	ASTA ALLUMINIO 2M PER CHIAVISTELLO PIATTO	VR10839J	10			2

INFORMAZIONI

Attrezzi Necessari

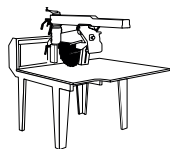

Sega circolare

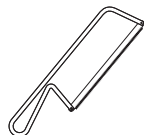

Seghetto per metallo

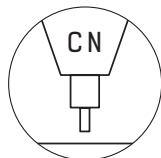

Lima

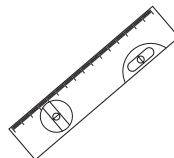

Livella

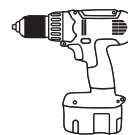

Trapano / Avvitatore



Punta per metallo

Ø13 mm
Ø10 mm
Ø7 mm
Ø4,5 mm



Cacciavite

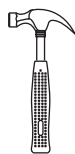

Martello

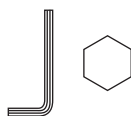

Chiave a brugola 2,5 e 8



Chiave a brugola T20 e T25



Chiave combinata 14



Frenafilotti

Caratteristiche tecniche

Larghezza massima : 500 mm

Altezza massima : 3 000 mm

Sbordo su facciata : 500 mm maxi.

Peso fino a 20kg / anta

Spessore : da 30 a 35 mm

Consigli

TORBEL declinerà ogni responsabilità se verranno montati componenti non previsti e non appartenenti a questa gamma. È compito del fabbricante assicurarsi che i componenti siano compatibili con le persiane. Il sistema dovrà essere posato da un professionista a regola d'arte rispettando tutte le NTC. Escludere la posa in prima linea costiera e nelle zone più ventose (Norma EN1991-1-4).

Rispettare le dimensioni massime per anta (3 m x 0,5 m x uno spessore compreso tra 30 e 35 mm) per un peso massimo di 20 kg per anta. Per il corretto funzionamento verificare che la struttura delle ante sia sufficientemente rigida e solida. Fissare saldamente il telaio (su una struttura sufficientemente resistente alle sollecitazioni del sistema) nei differenti singoli punti (i singoli punti si trovano a livello delle pomelle, delle battute inferiori e dei carrelli anta aperti e chiusi...) con la viteria adatta al sistema e al materiale della facciata. Utilizzare un fissaggio in ogni foro delle pomelle e dei chiavistelli previsti con la viteria adatta (vite per legno TF Ø5 o rivetto Ø4,8) in base al tipo di anta.

Prevedere delle aperture necessarie a far evacuare l'acqua soprattutto nella guida inferiore.

Il sistema si dovrà aprire e chiudere senza particolare sforzo (nessun attrito) e assicurarsi che non ci sia alcun ostacolo. Pulire e lubrificare regolarmente le pomelle e le ruote dei carrelli e delle guide inferiori. Sostituire i pezzi che presentano delle anomalie (usure importanti, rotture).

Verificare regolarmente la viteria, stringere o sostituire al bisogno.

Gli utenti sono tenuti a chiudere le persiane in caso di assenza e/o di avviso di vento forte (allerta arancione). Assicurarsi che i chiavistelli automatici siano posizionati correttamente quando le persiane sono chiuse, altrimenti aggiustarle manualmente.

È compito del produttore fornire all'utilizzatore finale i consigli di utilizzo e di pulizia dei nostri prodotti.

Altezza Anta = Altezza telaio - 87 mm

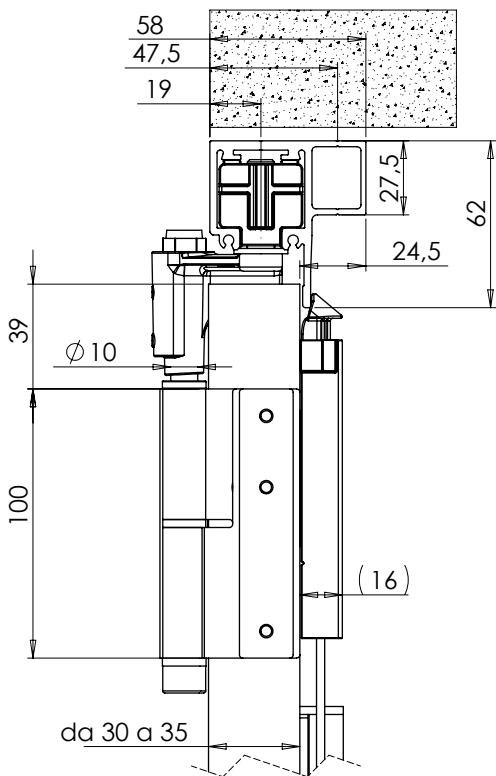

Lato esterno

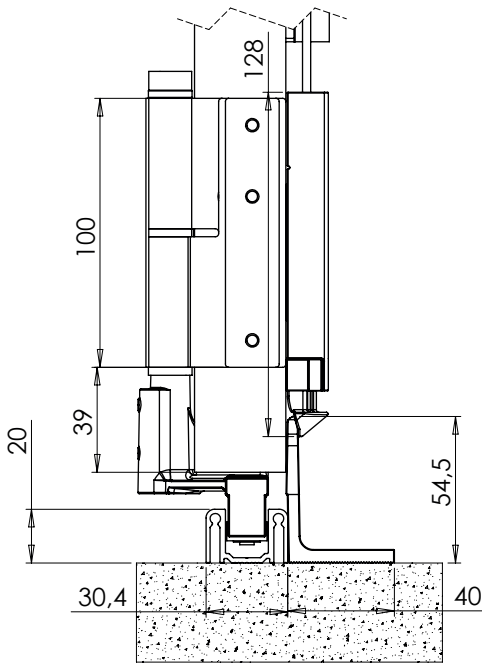

Lato interno

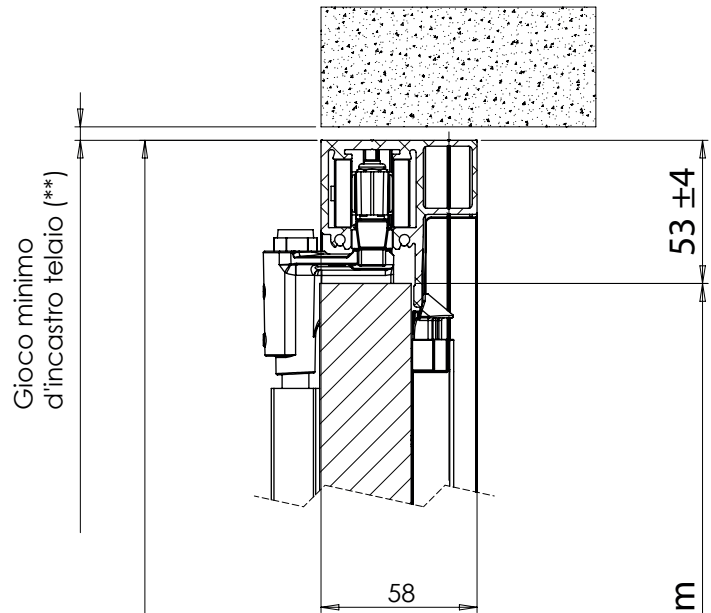

Gioco minimo d'incastro (**)

Altezza telaio

Altezza Anta = Altezza telaio - 87 mm

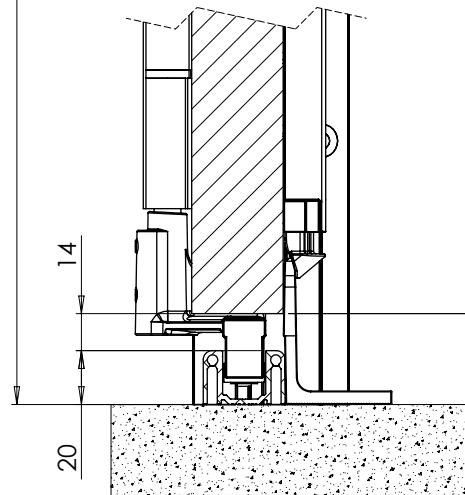

Lato esterno

Lato interno

(**) Sulle aperture di dimensioni minime suggeriamo un gioco minimo di incastro periferico del telaio di 5 mm

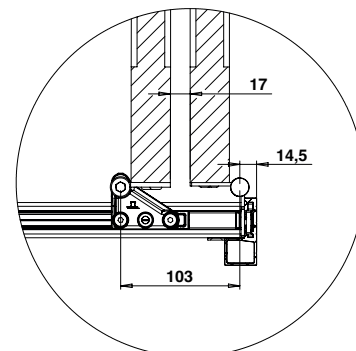
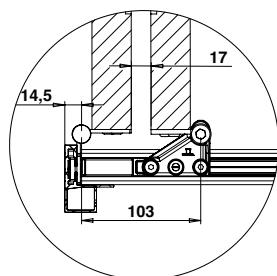

INTERNO

$$\text{Larghezza anta} = (L - J^{(*)} - 71) / 4$$

LATO ESTERNO

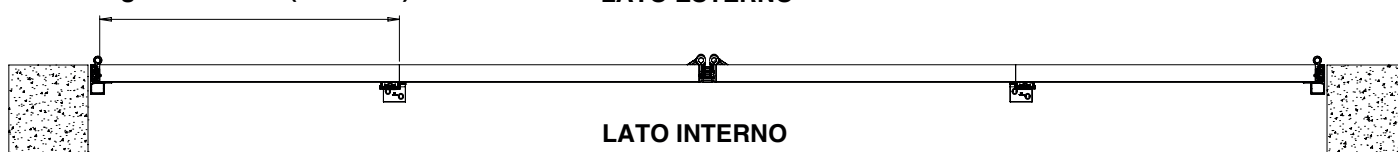

LATO INTERNO

Gioco minimo di incastro telaio (**)

LATO ESTERNO

$J = \text{Gioco di funzionamento}^{(*)}$

Gioco minimo di incastro telaio (**)

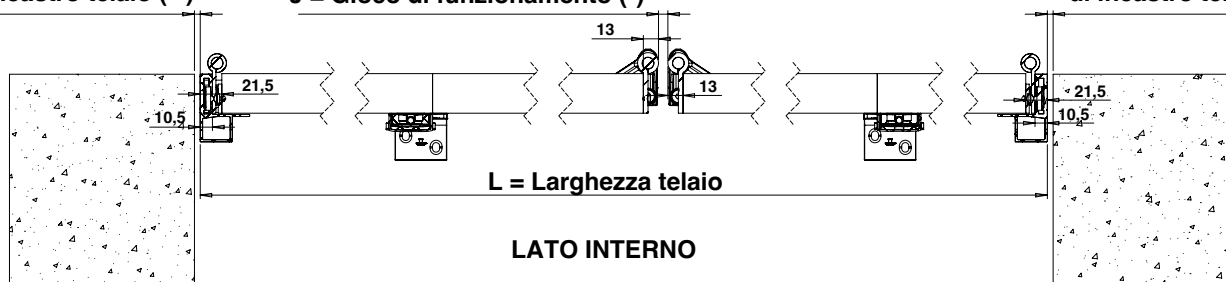

$L = \text{Larghezza telaio}$

LATO INTERNO

(*) Le jeu de fonctionnement J doit intégrer le recul du chariot lors de la fermeture, les tolérances dimensionnelles des vantaux et du précadre ainsi que les dilatations liées aux variations hygrométrique et thermique.

(*) Recul du chariot :

Vantail largeur 500 mm => 5 mm, 400 mm => 6.5 mm, 300 mm => 8.5 mm, 200 mm => 13 mm.

(**) Un jeu minimum d'encastrement périphérique au précadre de 5 mm est suggéré sur les dimensions minimums des ouvertures de baie.

1

Lavorazione dei profili

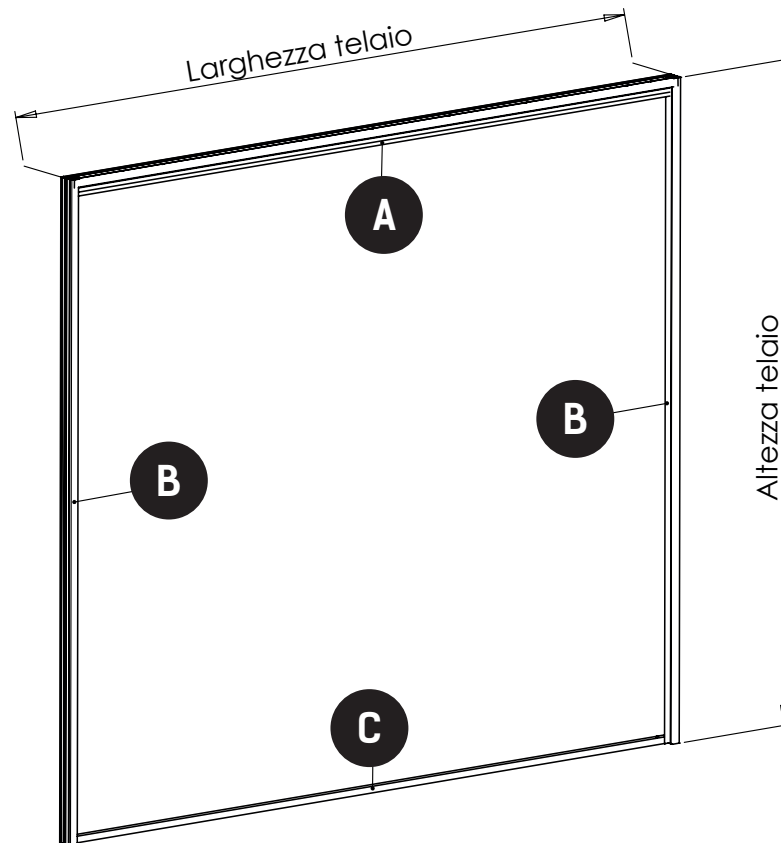

 <p>A VR10906</p>	<p>Lunghezza binario superiore = Larghezza del telaio - 21 mm</p>
 <p>B VR10917</p>	<p>Lunghezza profilo telaio laterale = Altezza telaio</p>
 <p>B VR10917</p>	<p>OPZIONE senza lavorazione CNC Con piastre di giunzione</p> <p>Lunghezza profilo telaio laterale = Altezza telaio - 62 mm</p> 
 <p>C VR10926</p>	<p>Lunghezza guida inferiore = Larghezza del telaio - 21 mm</p>

2

Foratura e lavorazione dei profili



I punti di fissaggio devono essere a livello dei singoli punti.

2.1

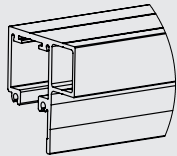

A VR10906

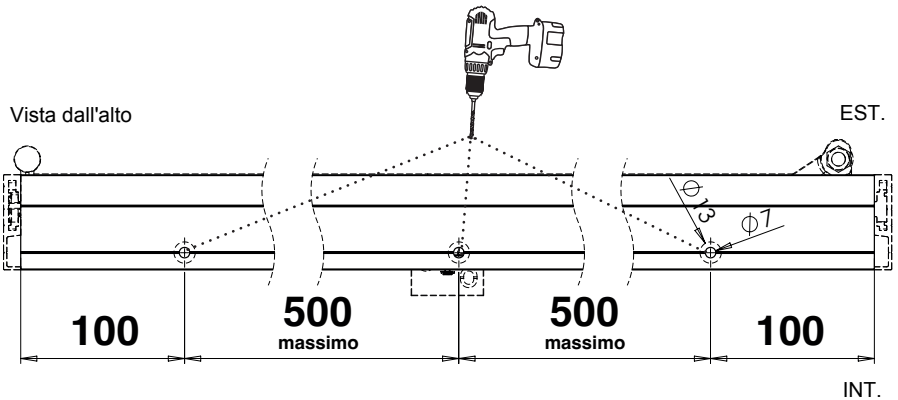

2.2

Prima della lavorazione

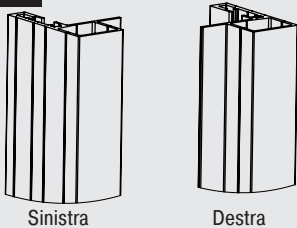

Sinistra

Destra

Dopo della lavorazione

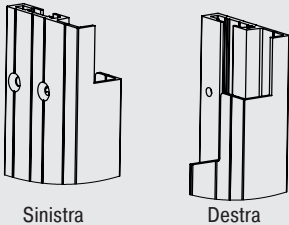

Sinistra

Destra

B VR10917

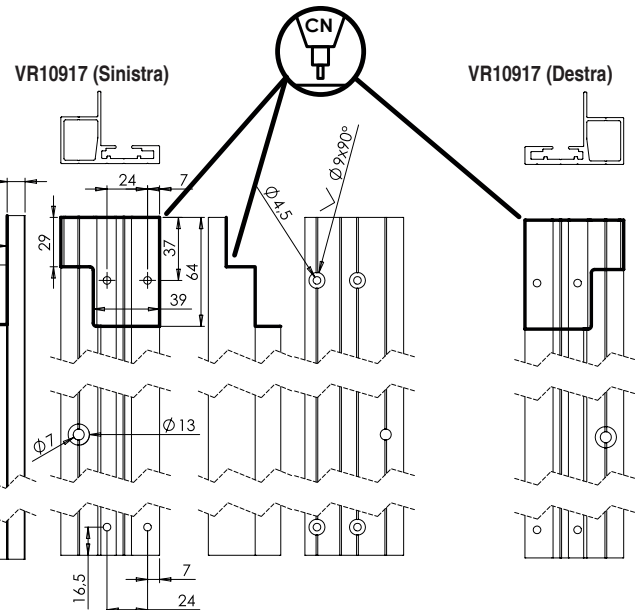
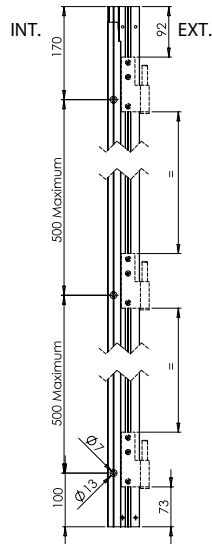

0

OPZIONE senza lavorazione CNC

Con piastre di giunzione

VR10917 (Sinistra)

VR10917 (Destra)

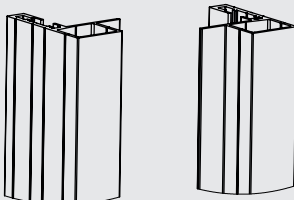

B VR10917

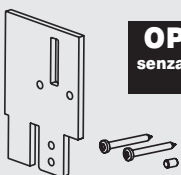

T VR10918

OPZIONE senza lavorazione CNC

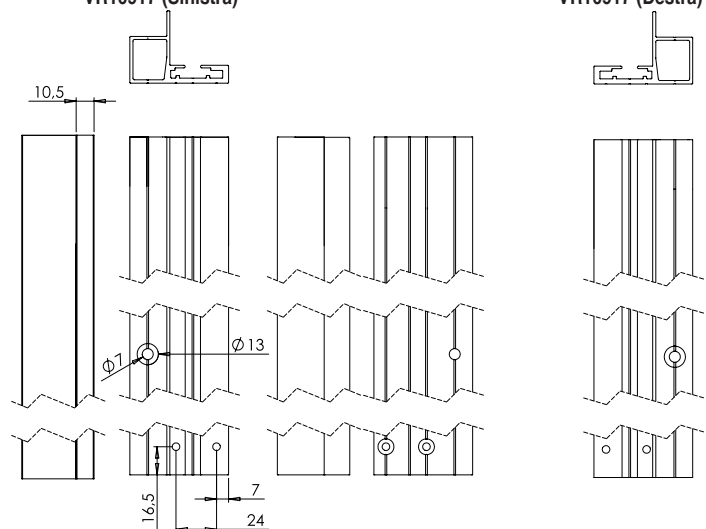
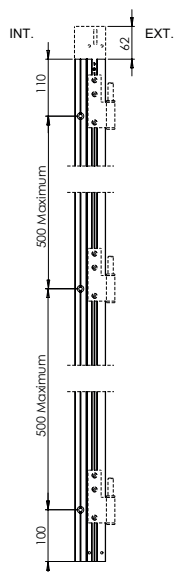

2

Foratura e lavorazione dei profili

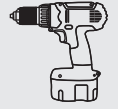

I punti di fissaggio devono essere a livello dei singoli punti.

2.3

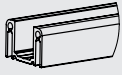

VR10926

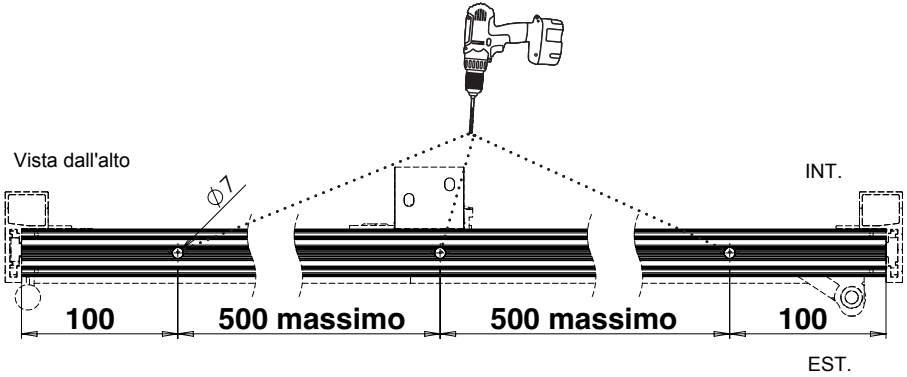

Drenaggio del binario di guida inferiore

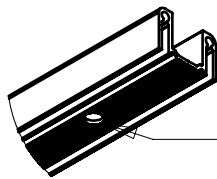
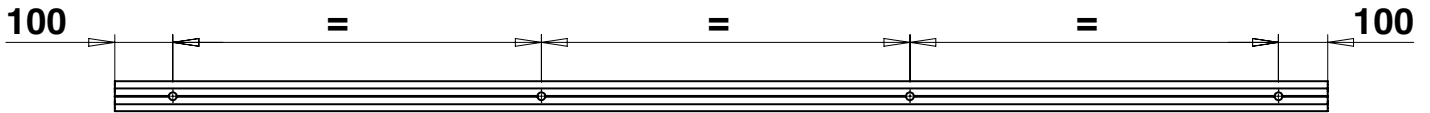
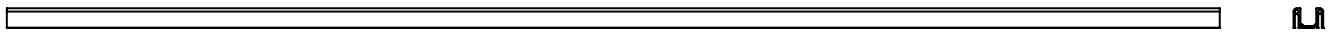

Drenaggio verticale Ø8

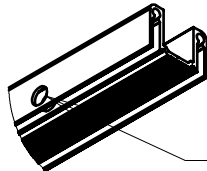

Drenaggio orizzontale Ø8
(orientato verso l'esterno)

3 Montaggio del telaio

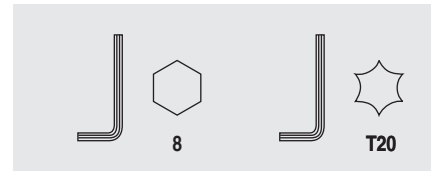

Per facilitare il montaggio e permettere la posa a terra del telaio, i passaggi qui di seguito sono orientati con vista dall'esterno.

3.1

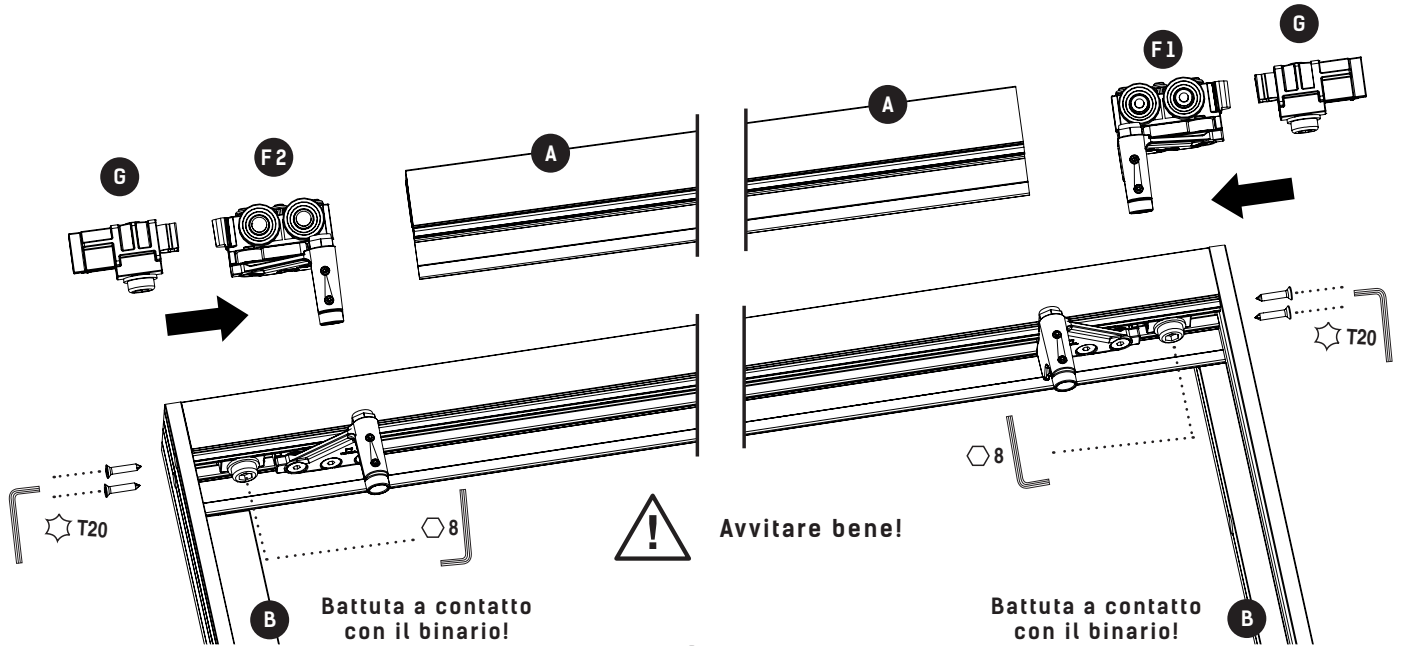
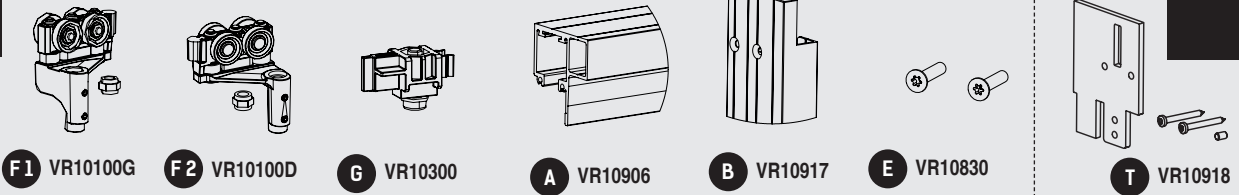

OPZIONE senza lavorazione CNC

Con piastre di giunzione

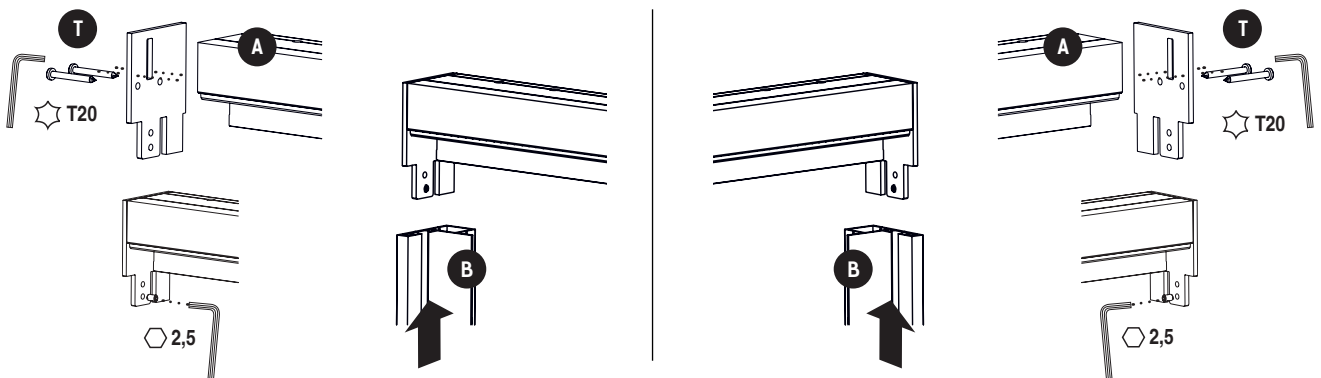

3.2

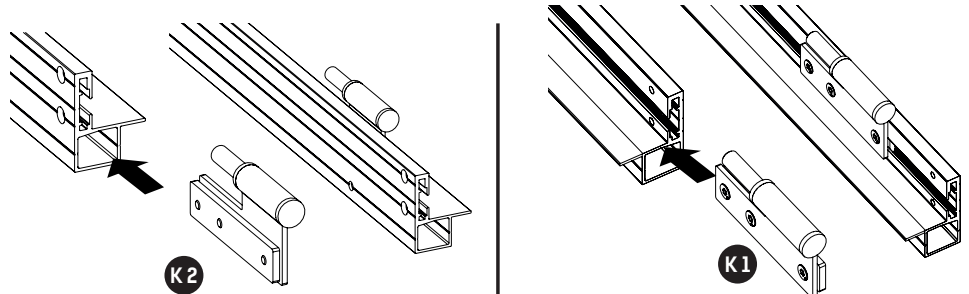
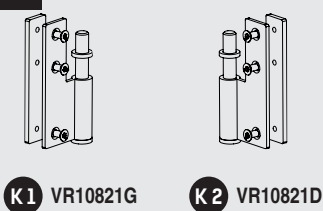

3

Montaggio del telaio

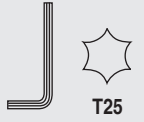

T25

Per facilitare il montaggio e permettere la posa a terra del telaio, i passaggi qui di seguito sono orientati con vista dall'esterno.

3.3

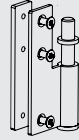

K1 VR10821G

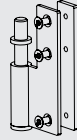

K2 VR10821D

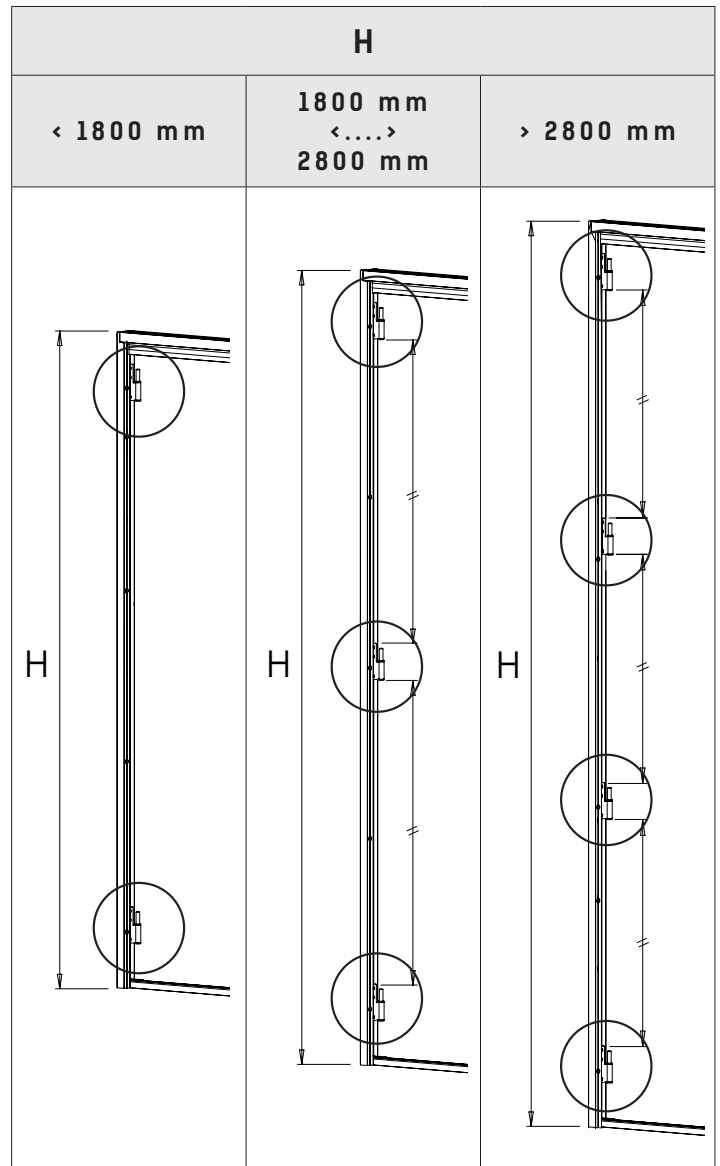
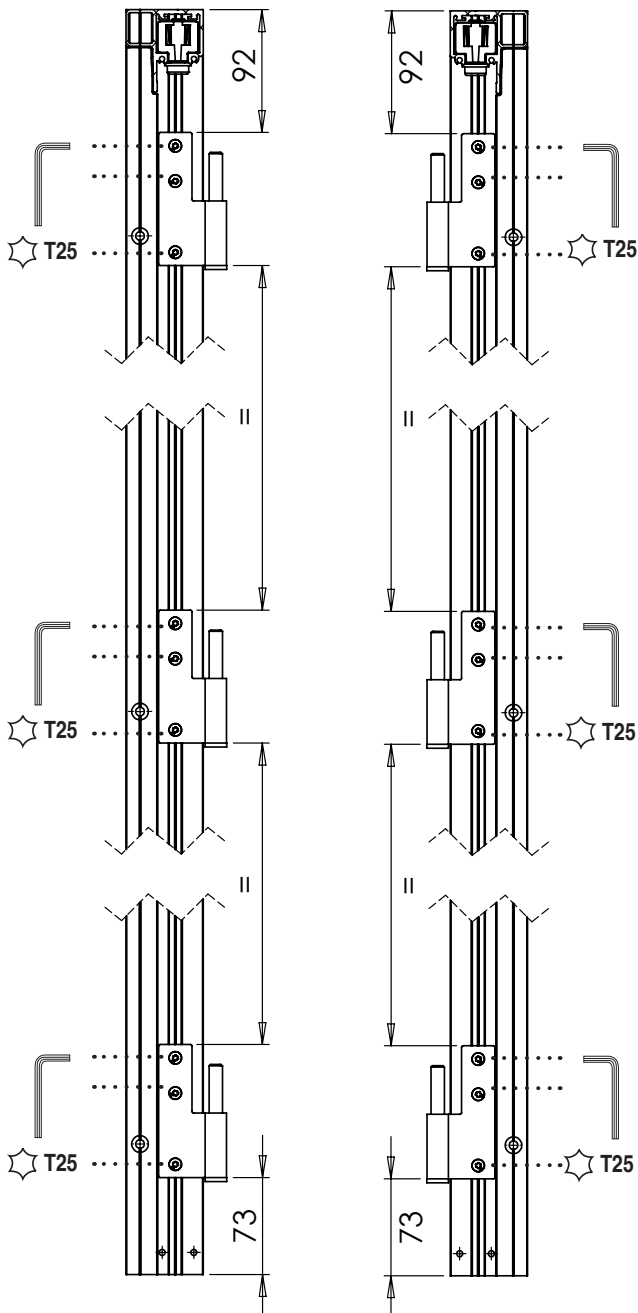

3 Montaggio del telaio

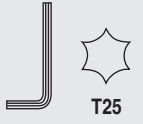

Per facilitare il montaggio e permettere la posa a terra del telaio, i passaggi qui di seguito sono orientati con vista dall'esterno.

3.4

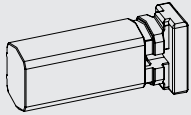

E VR10830

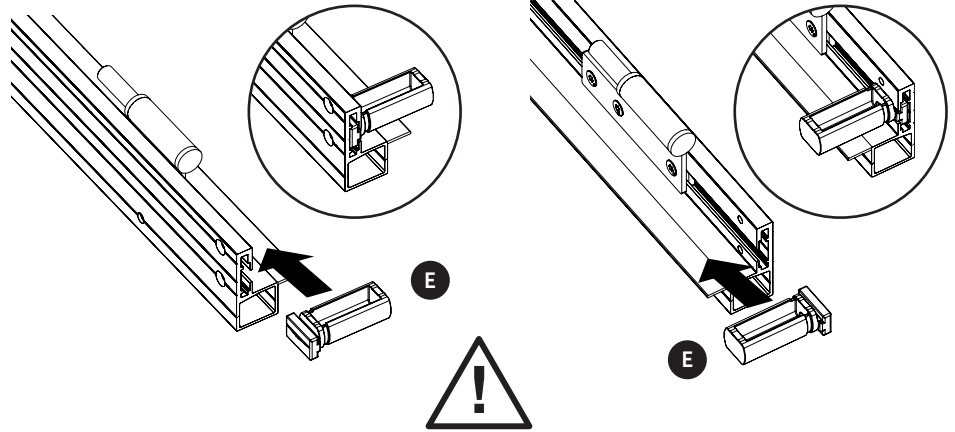

Attenzione al senso di posa della battuta!

3.5

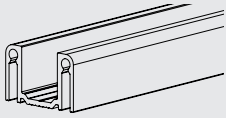

C VR10926

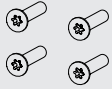

E VR10830

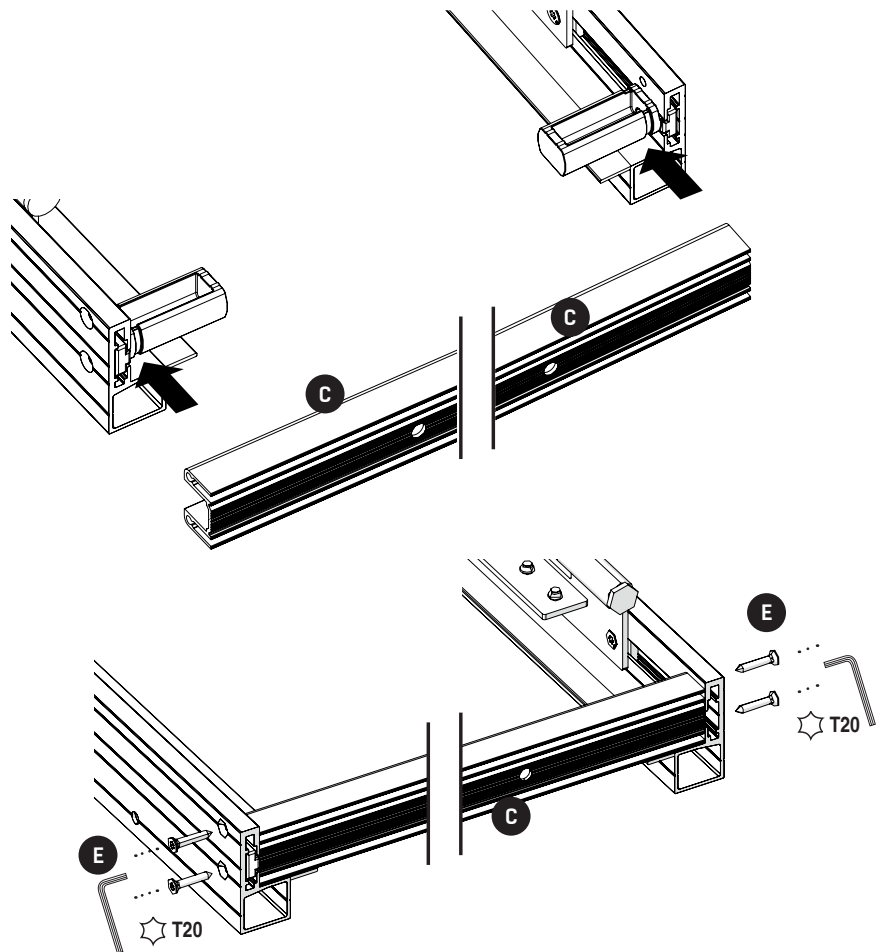

4

Preparazione delle ante

Vista dall'interno

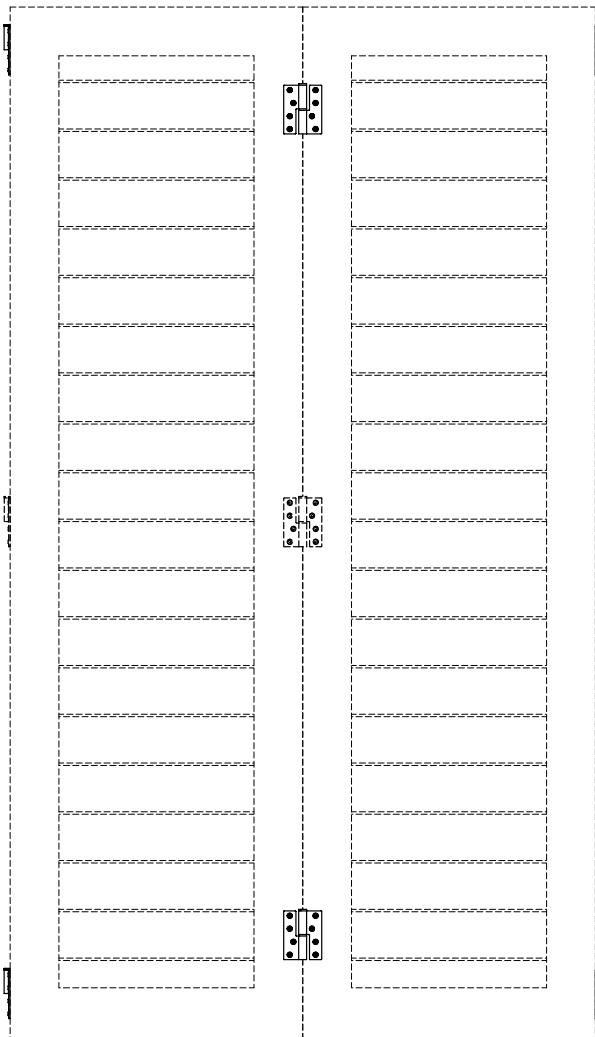

SINISTRA

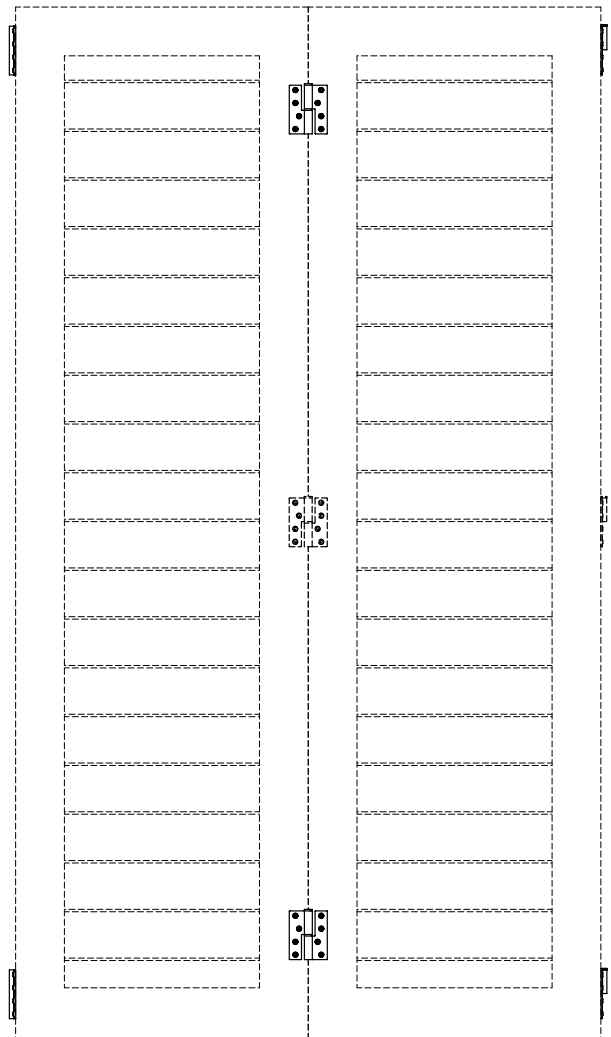

DESTRA

H		
< 1800 mm	1800 mm <....> 2800 mm	> 2800 mm

4

Preparazione delle ante SINISTRA Vista dall'interno

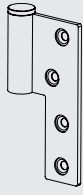

K1 VR10821G

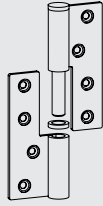

L1 VR10809G

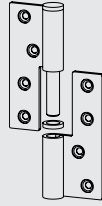

L2 VR10810D



O VR10818

Vista dall'interno

Perno verso il basso!

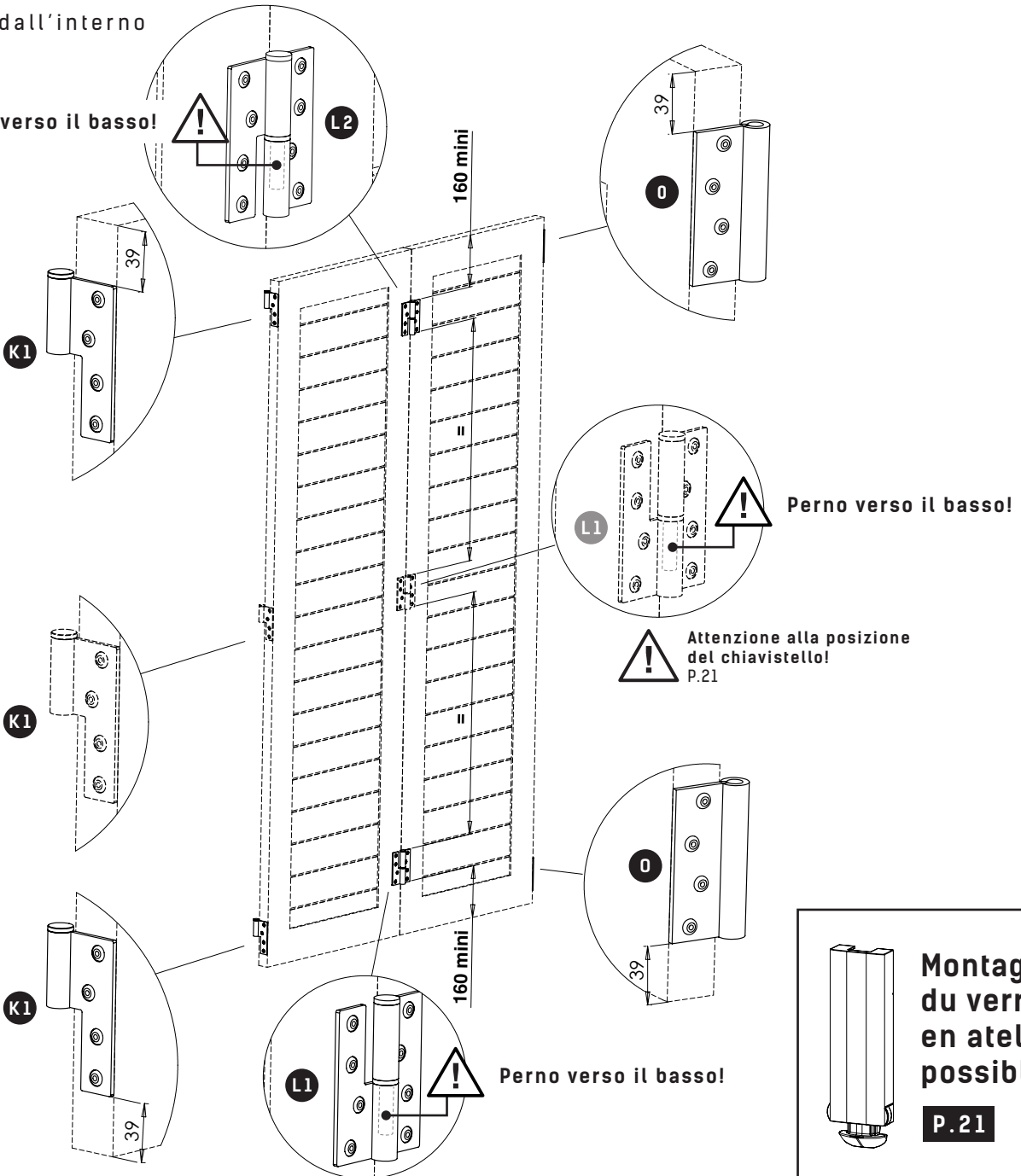

4

Preparazione delle ante DESTRA Vista dall'interno

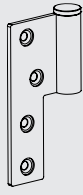

K2 VR10822D

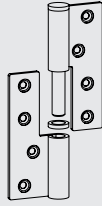

L1 VR10809G

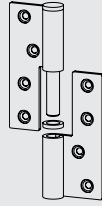

L2 VR10810D



O VR10818

Vista dall'interno

Perno verso il basso!

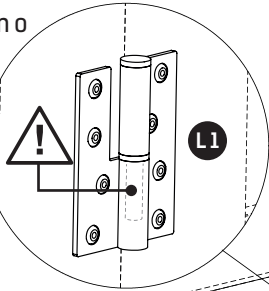

L1

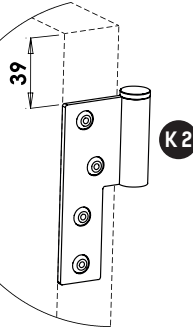

K2

O

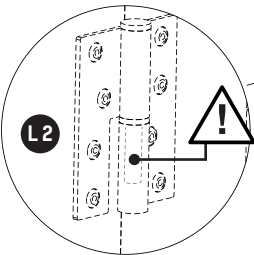
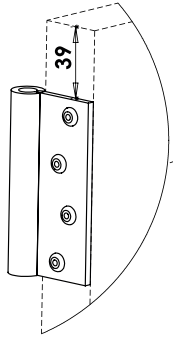

L2

Perno verso il basso!



Attenzione alla posizione del chiavistello!
P.21

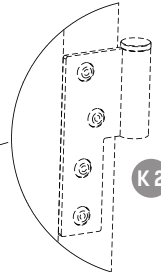

K2

O

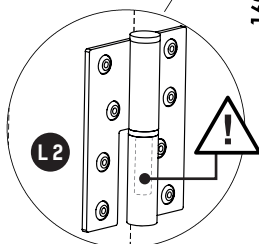
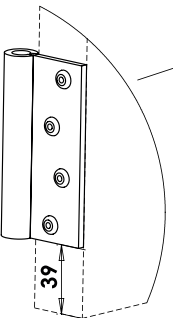

L2

Perno verso il basso!

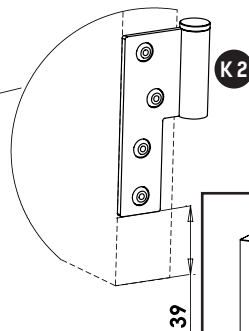

K2

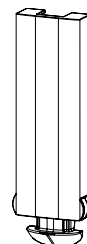

Possibilità di montaggio del chiavistello in officina

P.21

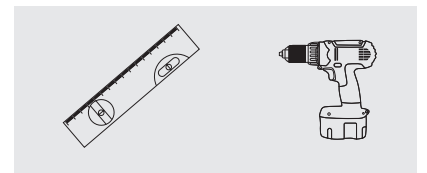

5 Installazione del telaio (regolazione geometrie e calibrzione)

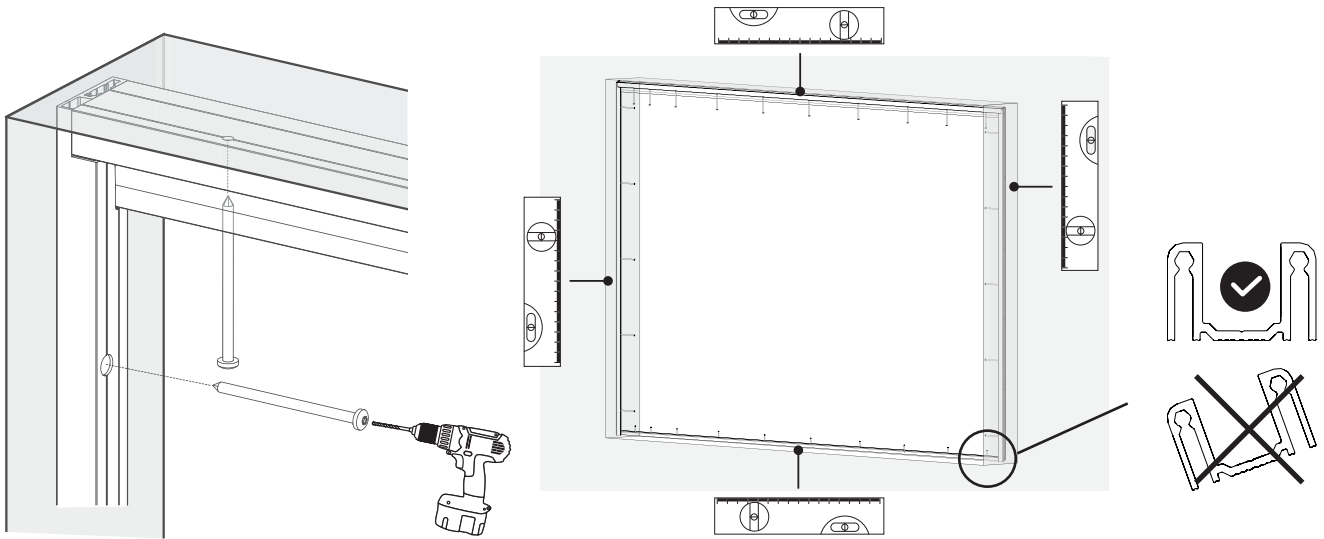

6 Montaggio delle ante

Vista dall'interno

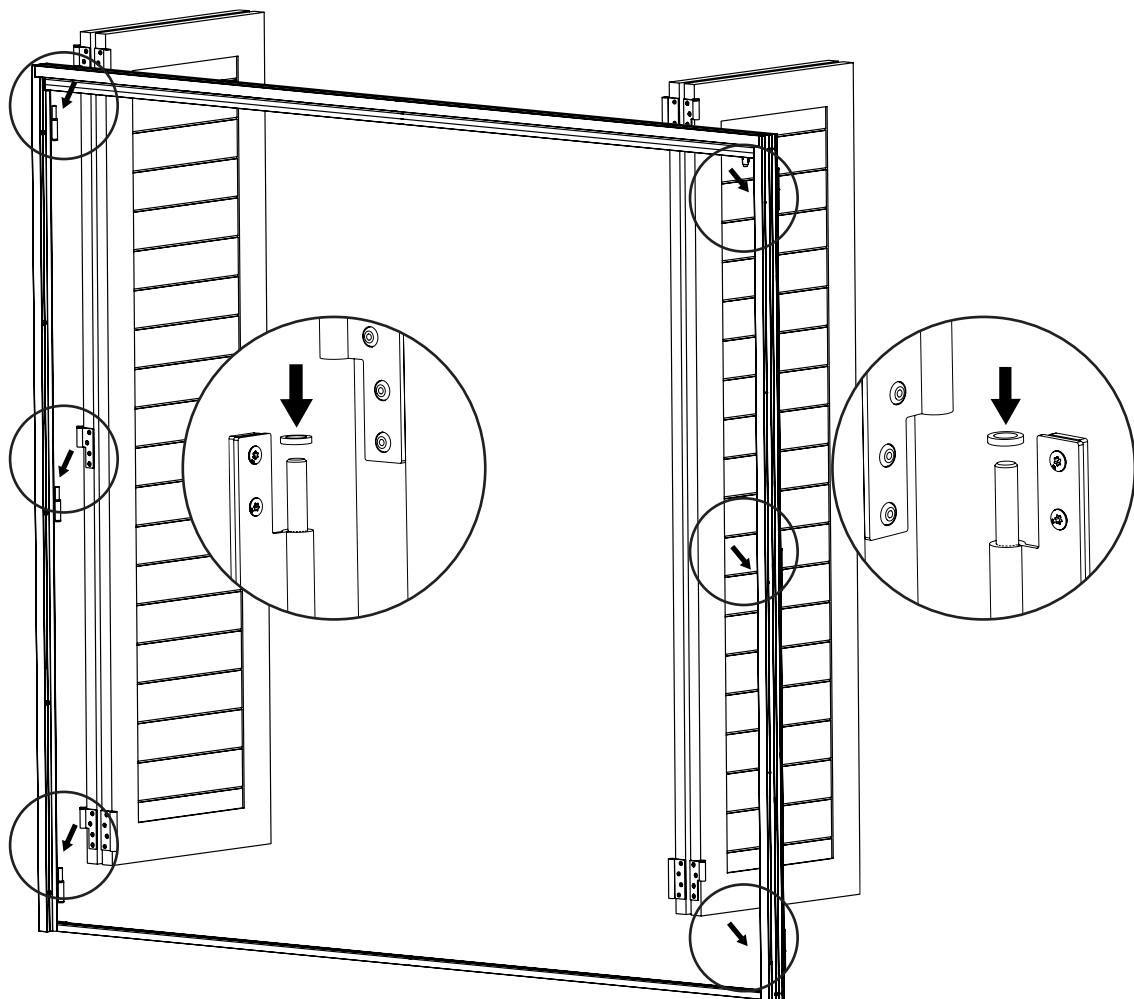

7

Montaggio delle guide

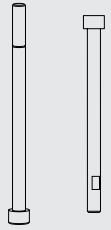
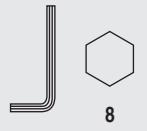

0 VR10818

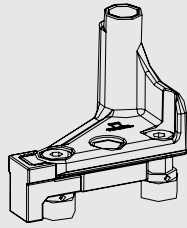

11 VR10400G



0 VR10818

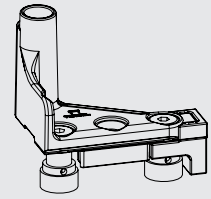

12 VR10500D

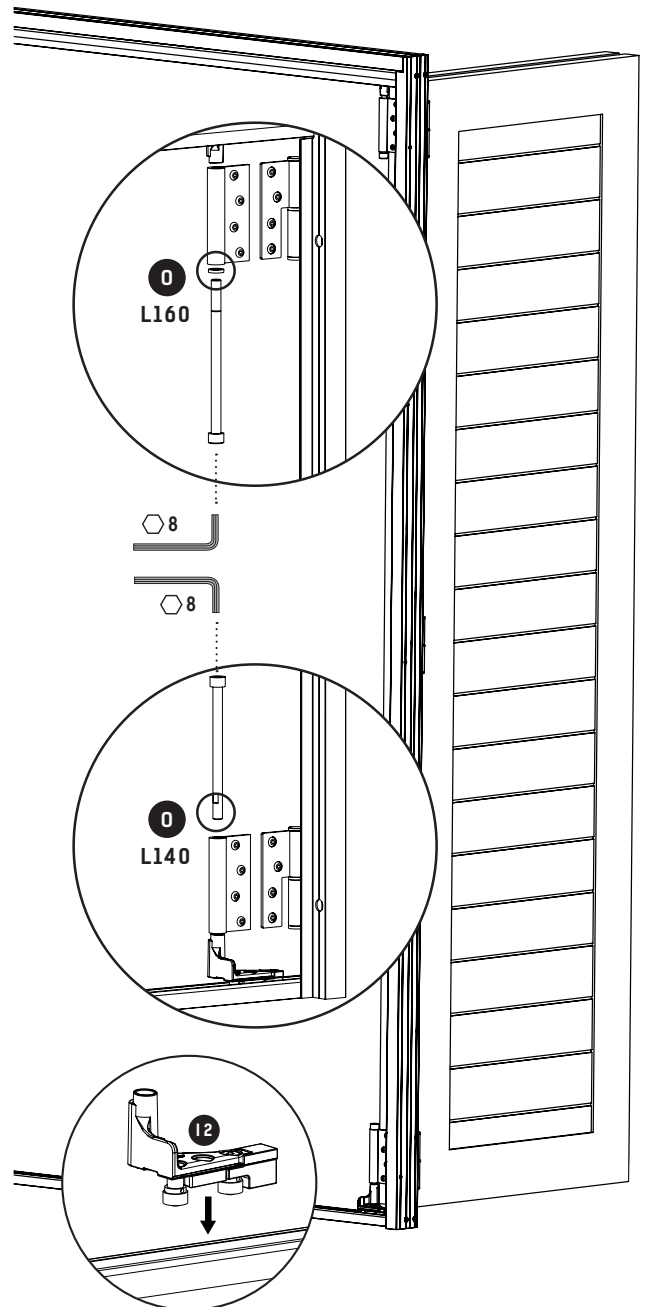
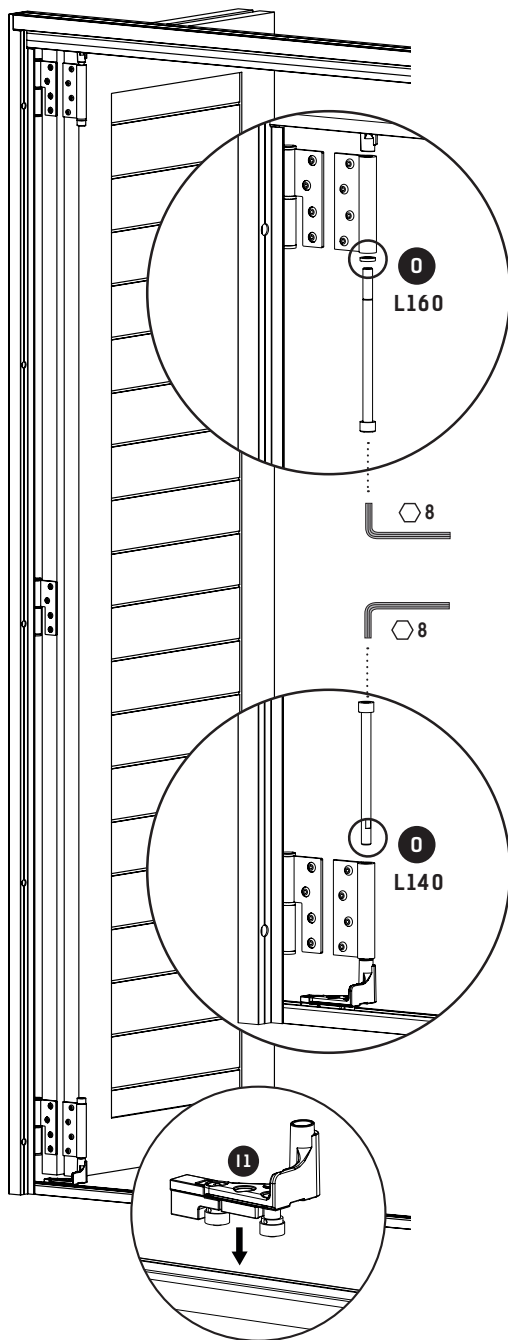

8 Regolazione

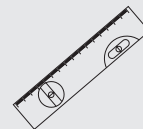

8.1

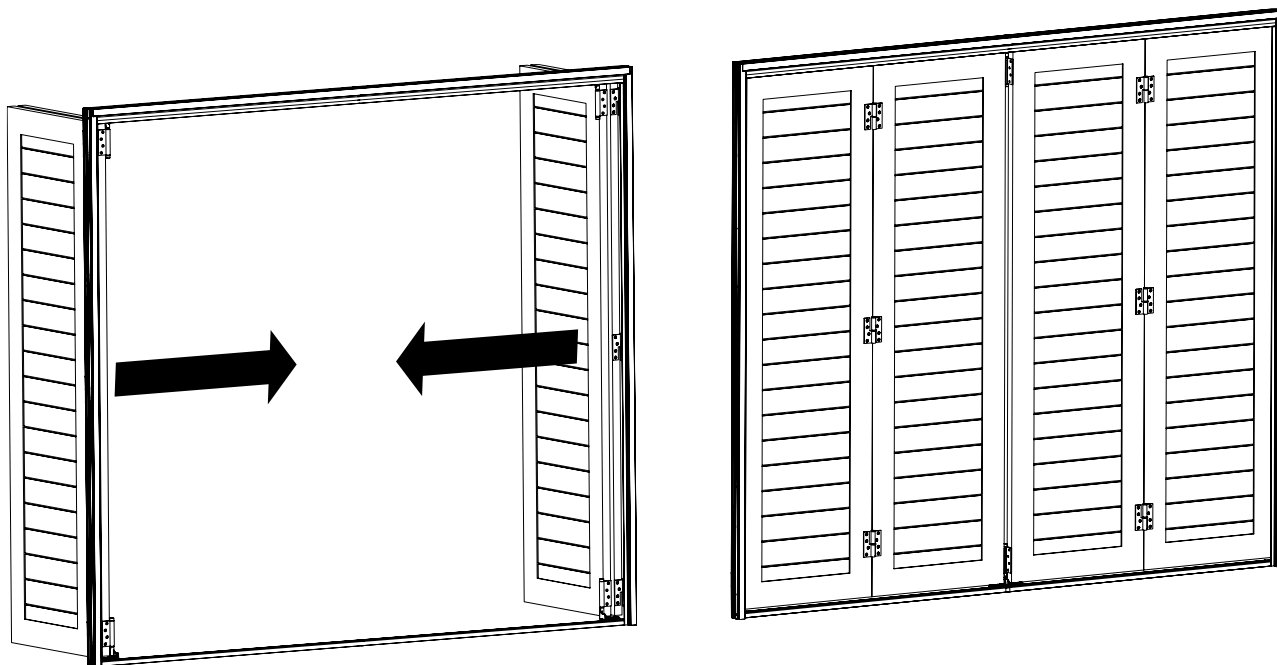

8.2



Verificare che la parte alta dello sbordo della ruota sia dentro il binario di 5mm per garantire una presa ottimale.

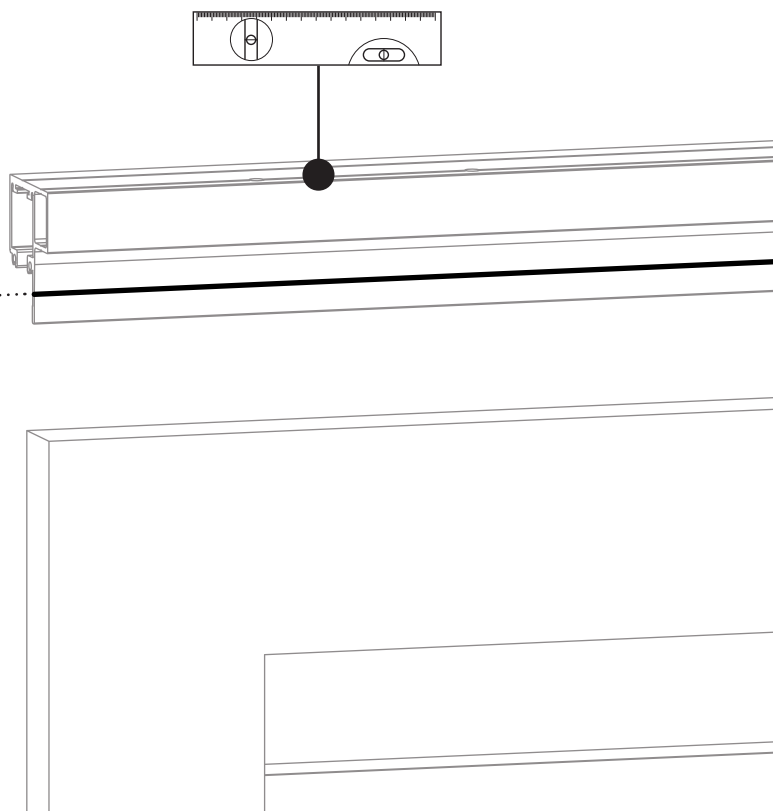

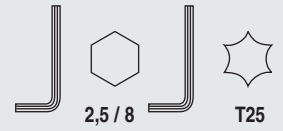

8.3

Vista dall'interno

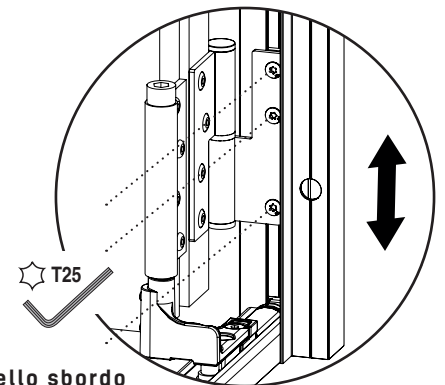
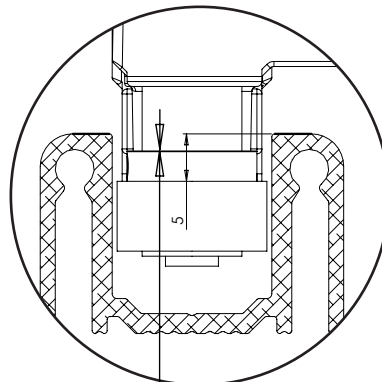
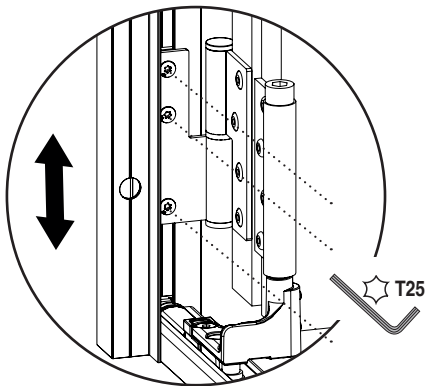
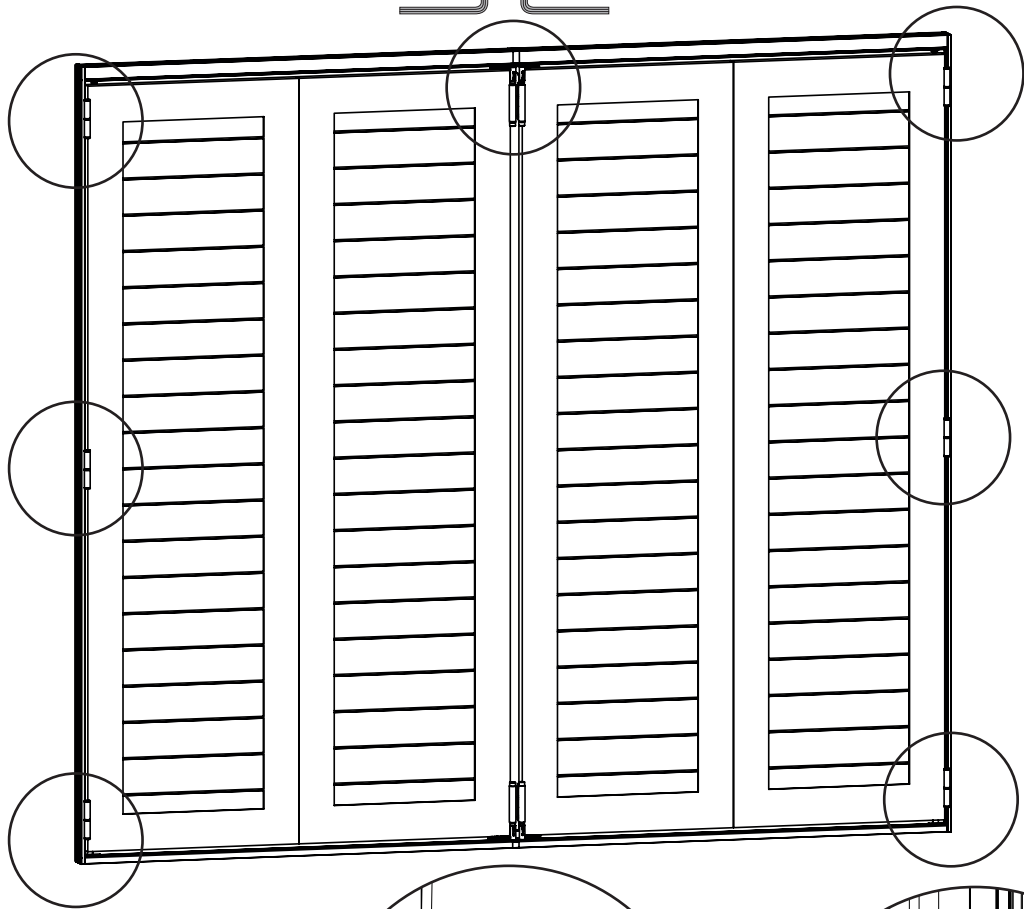
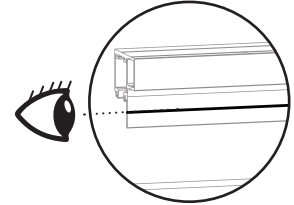
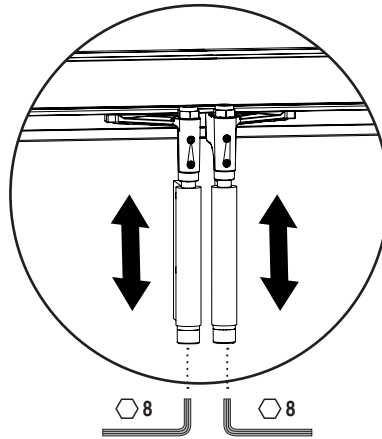

Verificare che la parte alta dello sordo della ruota sia dentro il binario di 5mm per garantire una presa ottimale.



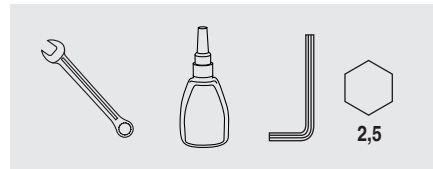

8.4 Fissaggio di sicurezza

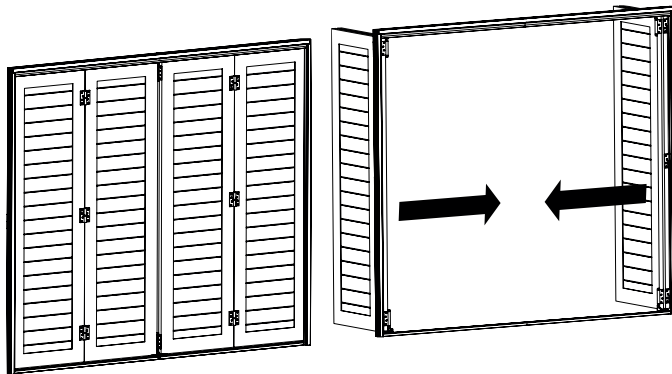

Fissaggio di sicurezza

Frenafiletti

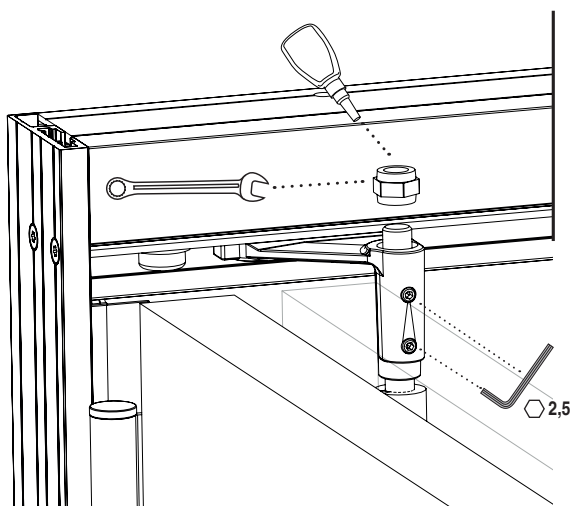

Frenafiletti

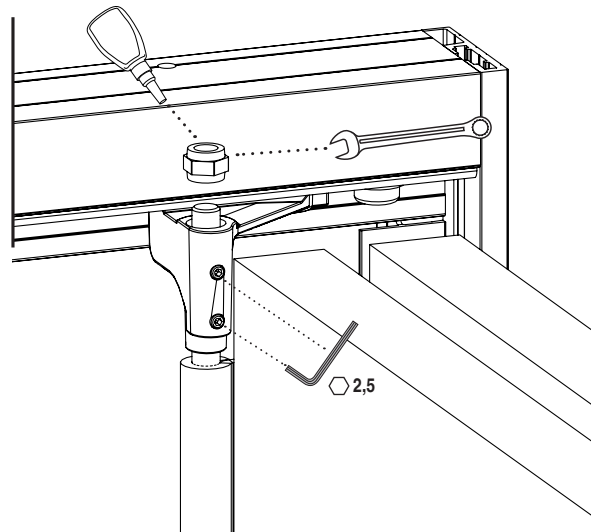

Frenafiletti

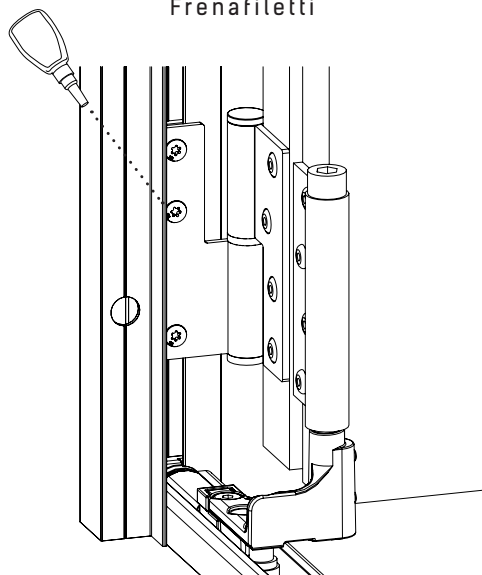

Frenafiletti

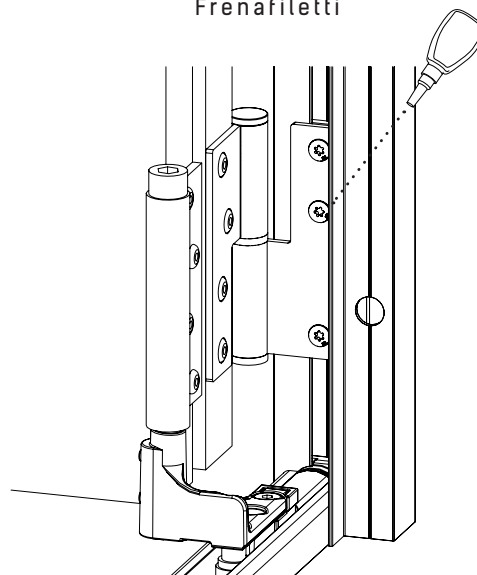

9

Montaggio del chiavistello e della battuta

9.1

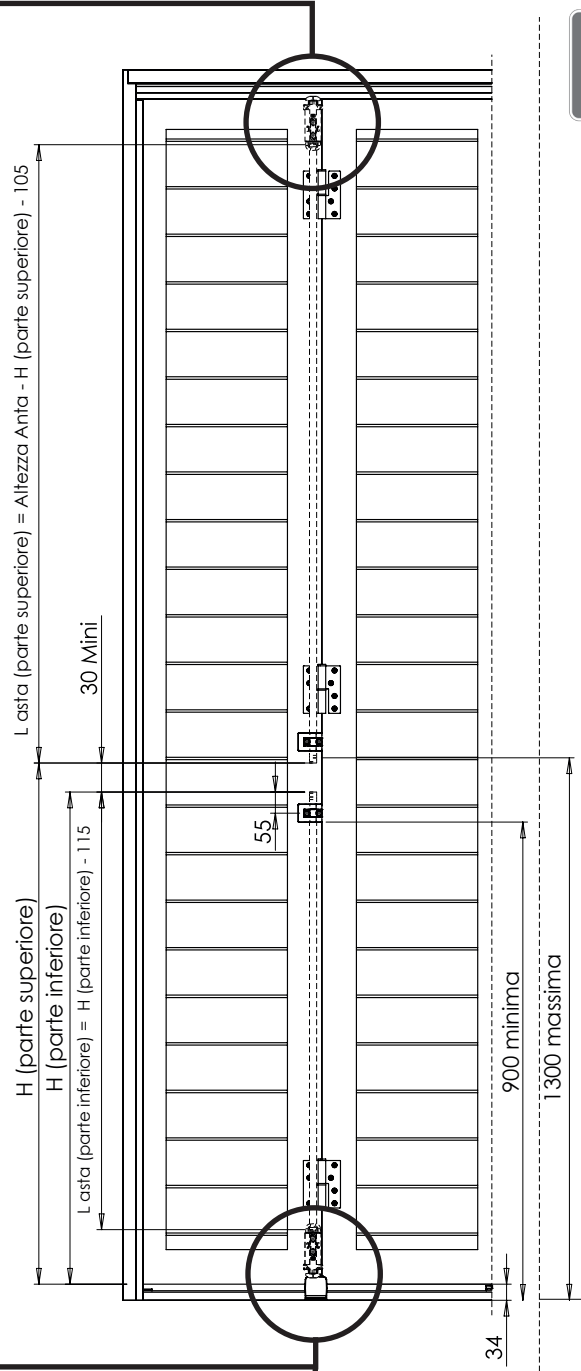
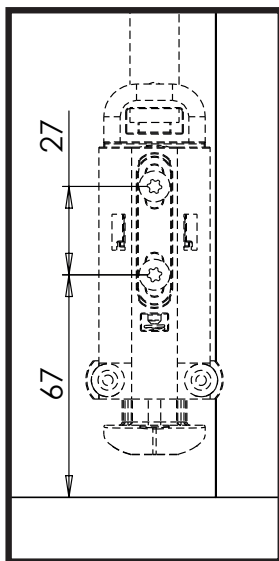
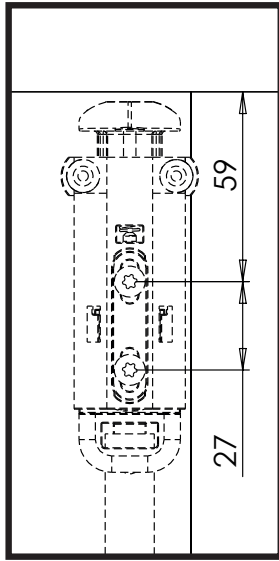

9

Montaggio del chiavistello e della battuta

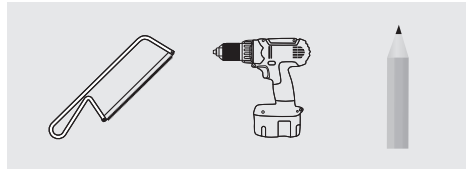

9.2

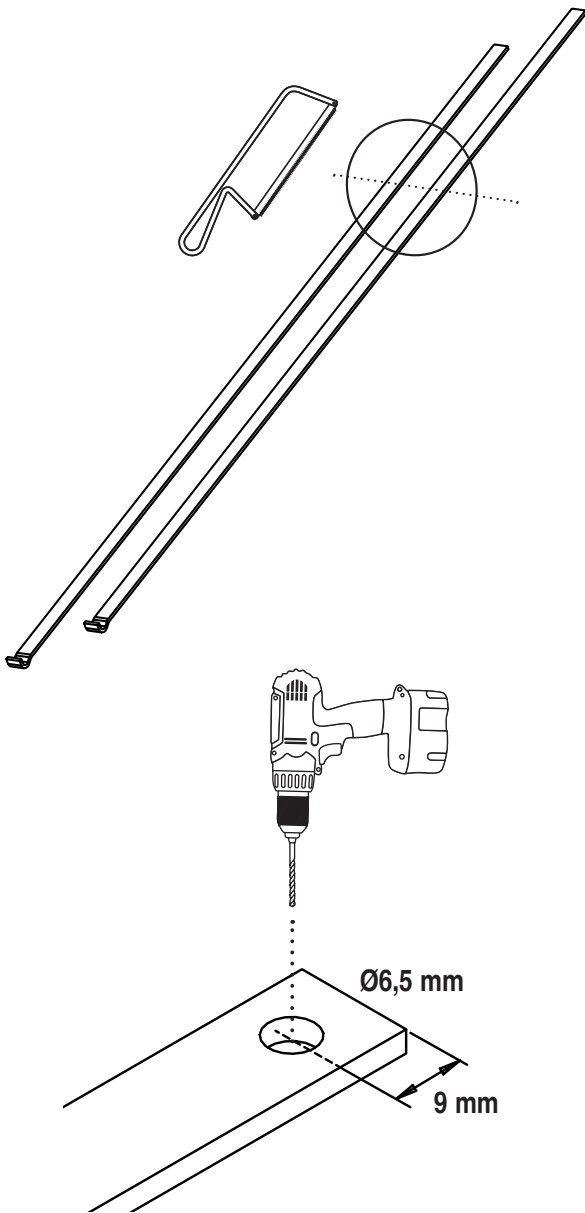
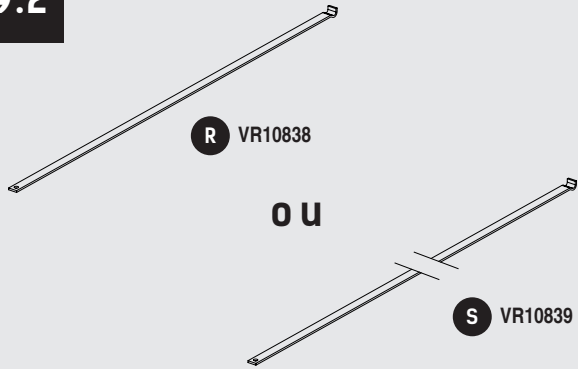

9.3

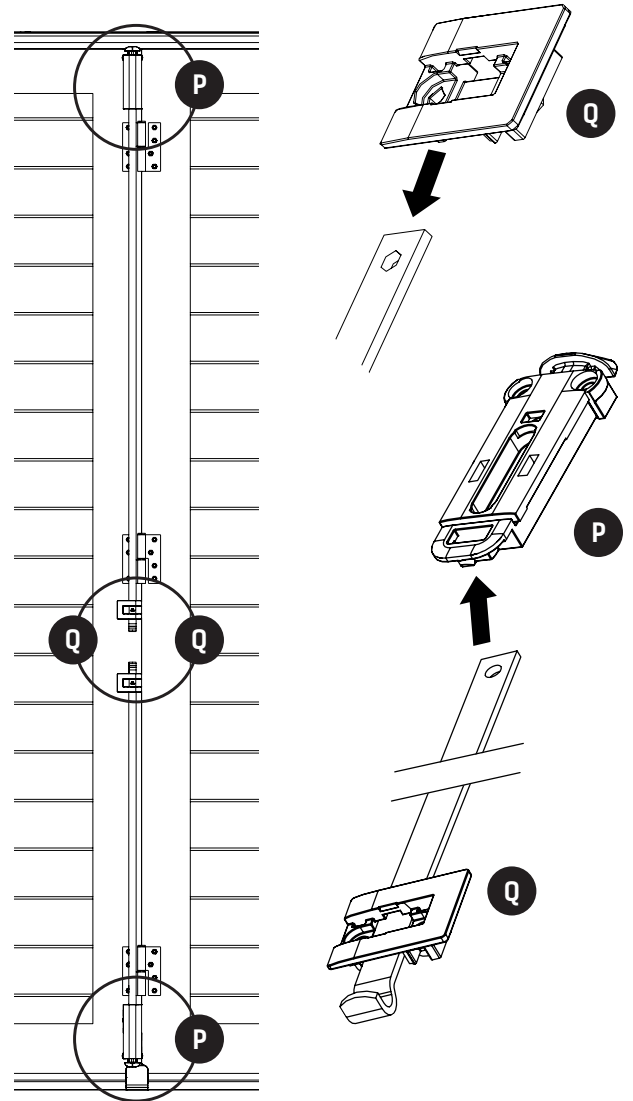
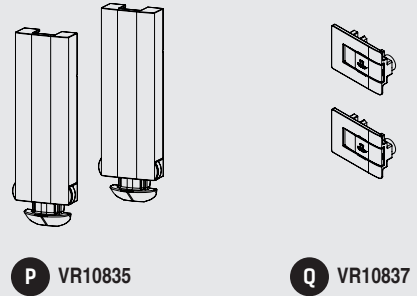

9

Montaggio del chiavistello e della battuta

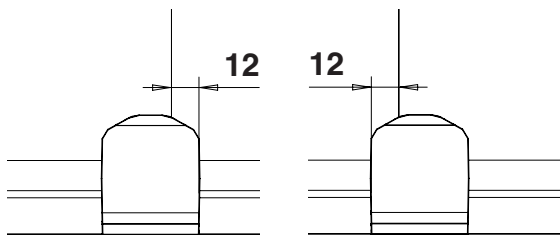
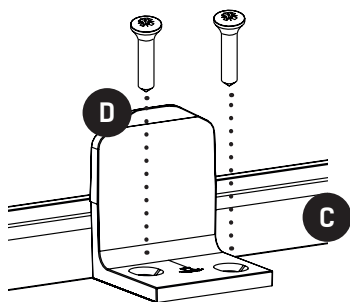
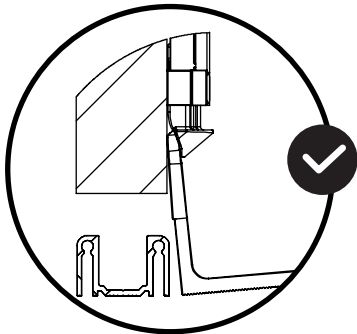
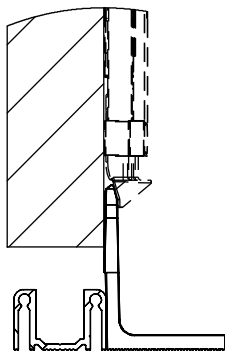
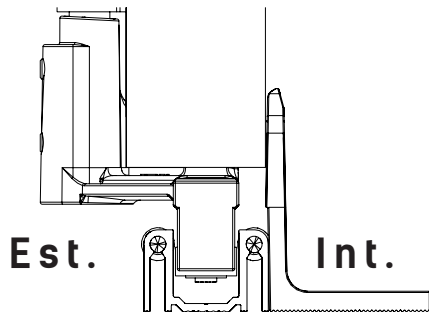
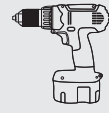

Posizione battuta sinistra

Posizione battuta destra

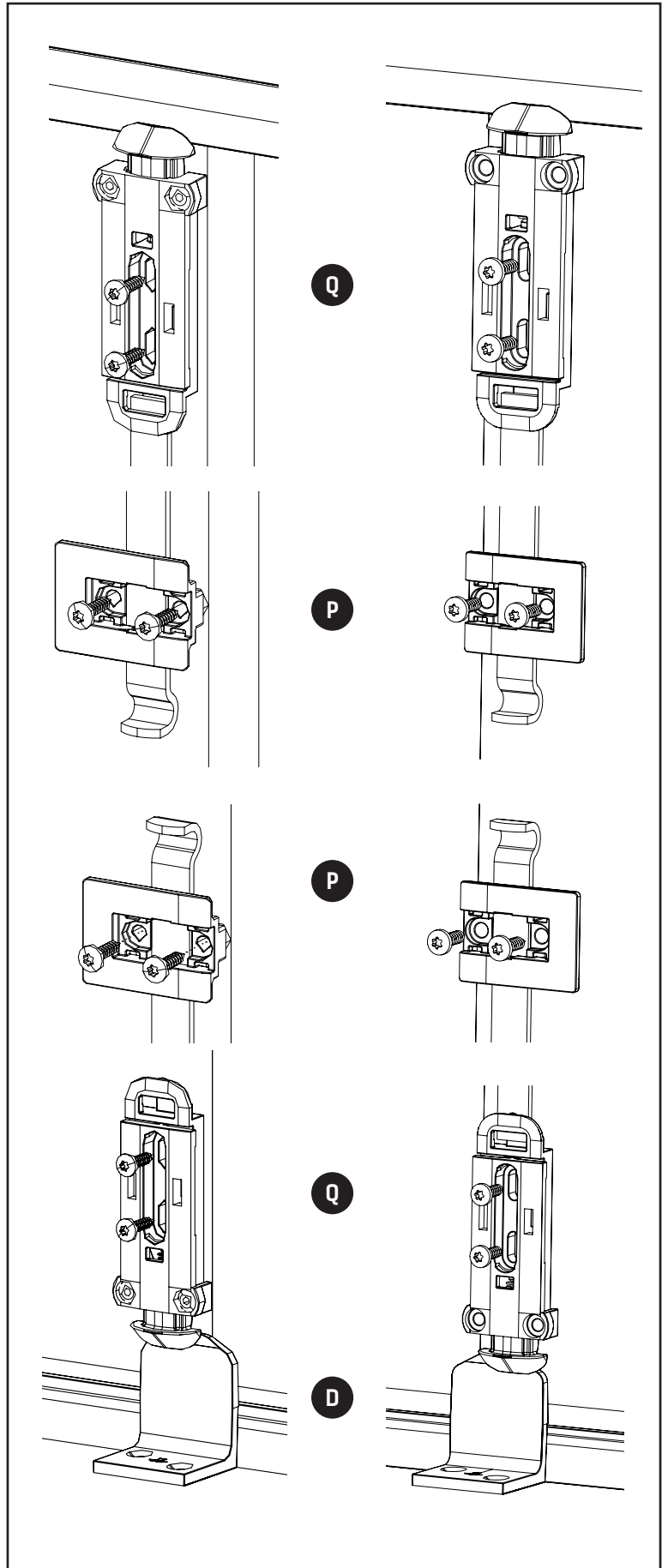

9

Montaggio del chiavistello e della battuta

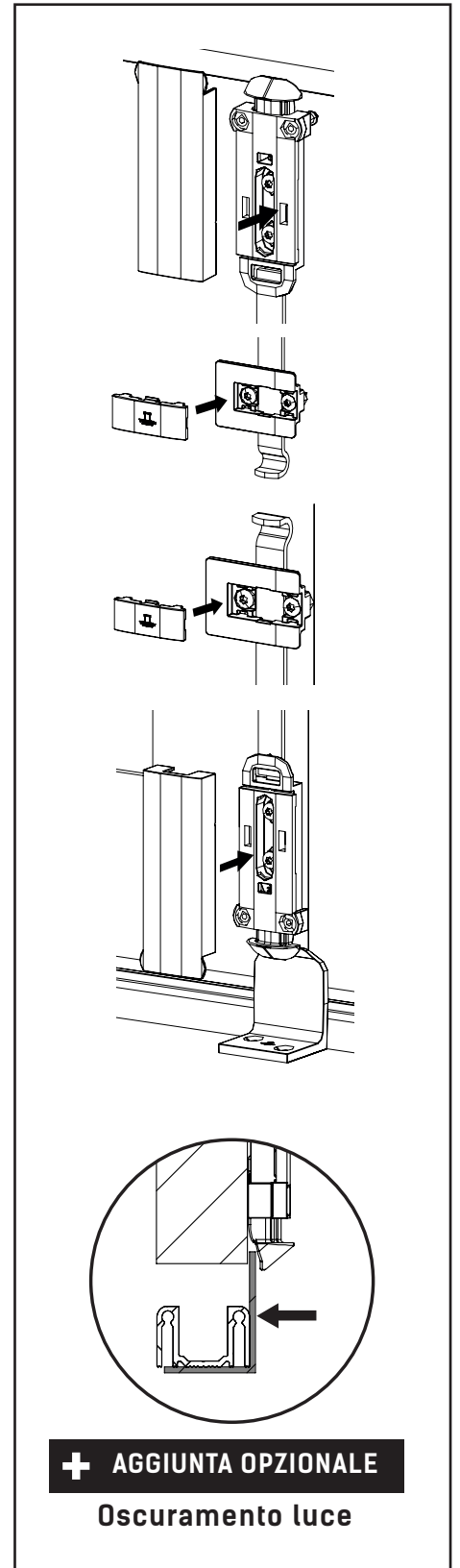
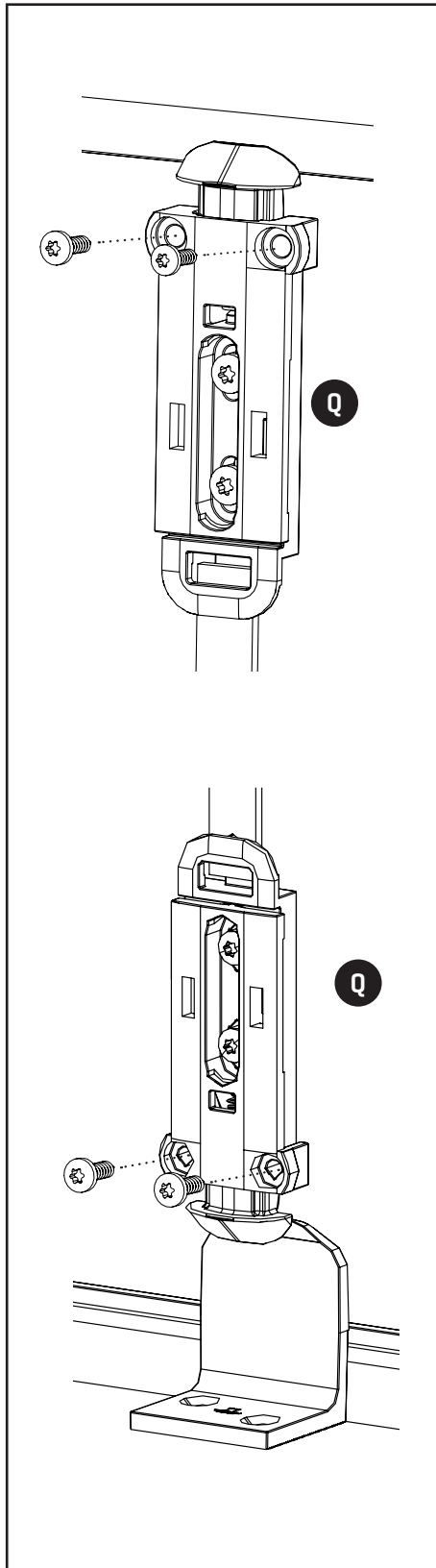
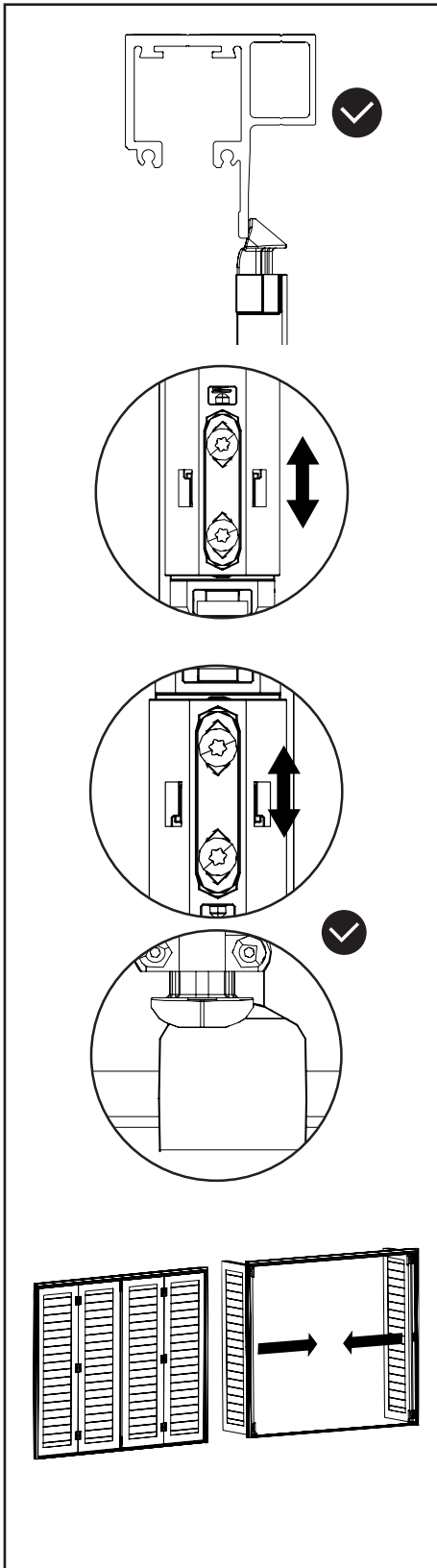
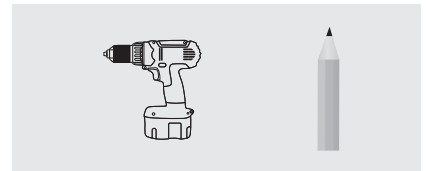

+ AGGIUNTA OPZIONALE
Oscuramento luce

✓ L'installazione è completata !

TORBEL® SRL

Via Brandizzo, 121/G - 10088 Volpiano (TO)
 Tel : +39 011 995 56 12 - info@torbel.it - www.torbel.it

