

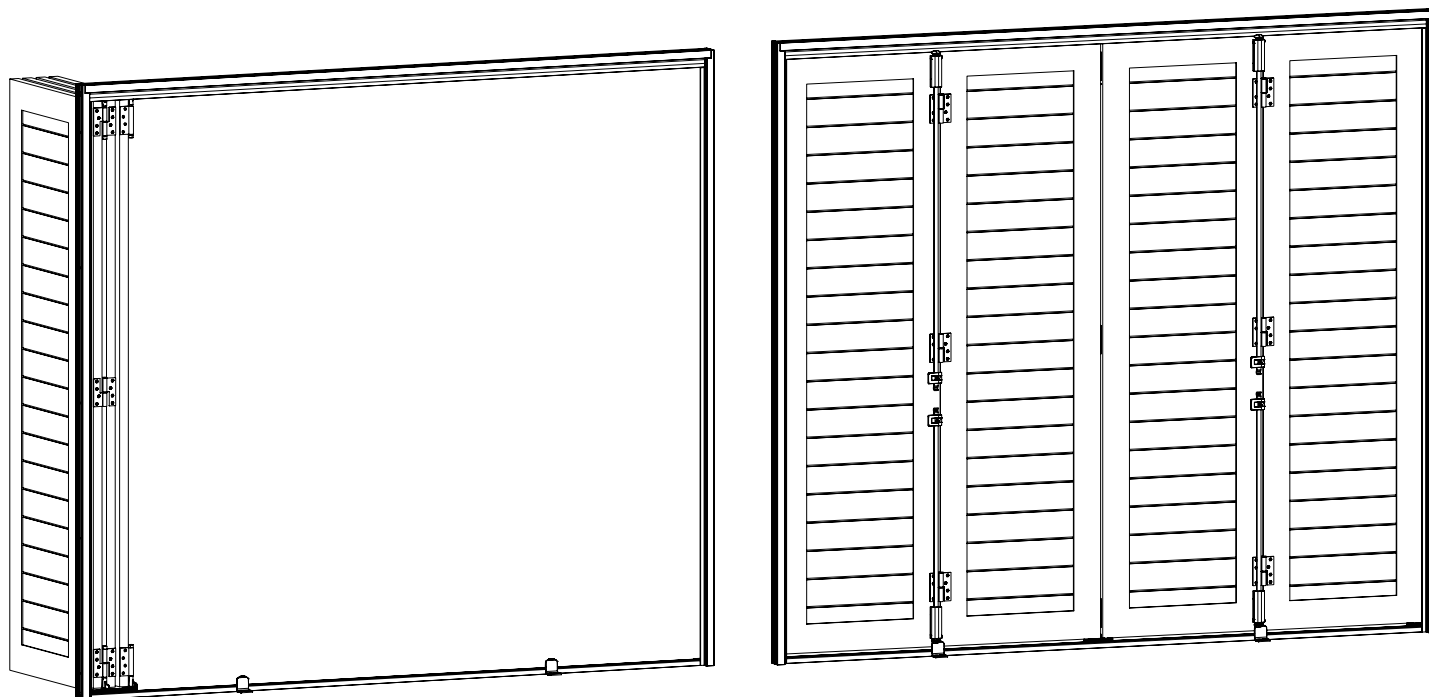

# Istruzioni di posa

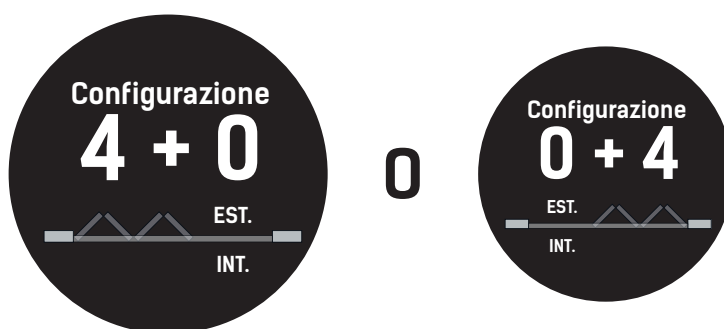

Vista dall'interno



## Gamma VCP300

Ferramenta per persiane scorrevoli ripieghevoli  
Per configurazione 4+0 o 0+4

# Componenti

## PROFILI E ACCESSORI PER TELAIO IN ALLUMINIO

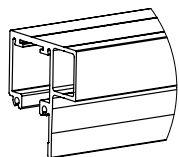

**A** VR10906

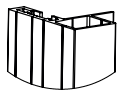

**B** VR10917

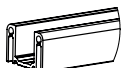

**C** VR10926

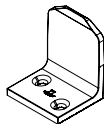

**D** VR10930

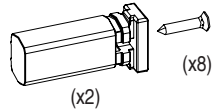

**E** VR10830

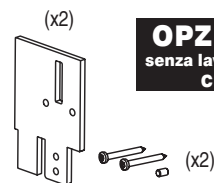

**T** VR10918

**OPZIONE**  
senza lavorazione  
CNC

## SCORRIMENTO SUPERIORE

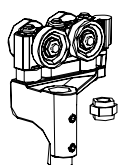

**F1** VR10100G

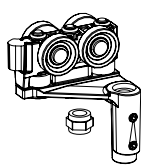

**F2** VR10200D

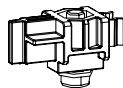

**G** VR10300

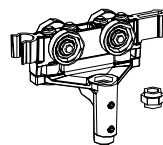

**H1** VR10700G

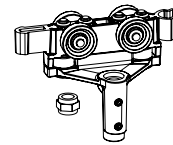

**H2** VR10600D

## SCORRIMENTO INFERIORE

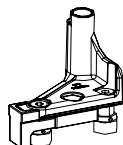

**I1** VR10400G

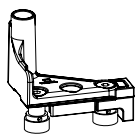

**I2** VR10500D

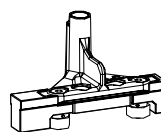

**J1** VR10800G

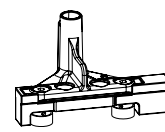

**J2** VR10801D

## COLLEGAMENTO PROFILI/ANTE

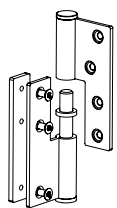

**K1** VR10821G

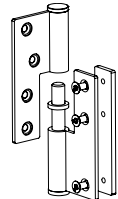

**K2** VR10822D

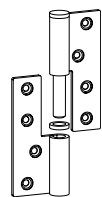

**L1** VR10809G

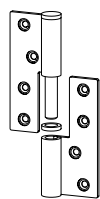

**L2** VR10810D

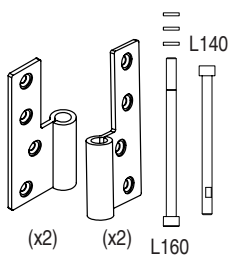

**M** VR10828

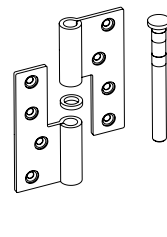

**N1** VR10816G

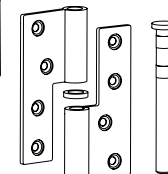

**N2** VR10817D

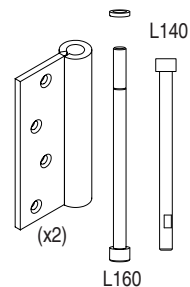

**O** VR10818

## CHIUSURA

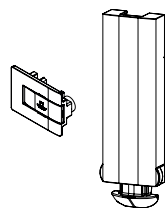

**P** VR10835



**Q** VR10837

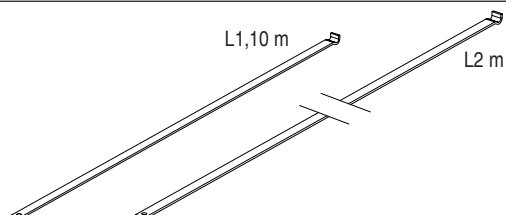

**R** VR10838J

**S** VR10839J

Descrizione		Codice	Conf.	H anta < 1800 mm		1800 <= H anta > 2800 mm		2800 <= H anta > = 3000 mm	
				4+0	0+4	4+0	0+4	4+0	0+4
				UnitàUnità	UnitàUnità	UnitàUnità	UnitàUnità	UnitàUnità	UnitàUnità
<b>PROFILI E ACCESSORI PER TELAIO IN ALLUMINIO</b>									
<b>A</b>	BINARIO SUPERIORE IN ALLUMINIO 6M	VR10906	9	1	1	1	1	1	1
<b>B</b>	PROFILO TELAIO LATERALE CON BATTUTA IN ALLUMINIO 6 M	VR10917	9	1	1	1	1	1	1
<b>C</b>	GUIDA A U INFERIORE IN ALLUMINIO 6M	VR10926	9	1	1	1	1	1	1
<b>D</b>	BATTUTA INFERIORE ZAMA PER GUIDA A U INFERIORE	VR10930	1	2	2	2	2	2	2
<b>E</b>	KIT 2 BATTUTE FISSE NYLON PER GUIDA INFERIORE + VITI	VR10830	1	1	1	1	1	1	1
<b>T</b>	KIT 2 PIASTRE DI GIUNZIONE PER CONTROTELAIO	<b>OPZIONE senza lavorazione CNC</b> VR10918	1	1	1	1	1	1	1
<b>SCORRIMENTO SUPERIORE</b>									
<b>F1</b>	CARRELLO SUPERIORE ESTERNO SINISTRO VISTA INTERNA	VR10100G	1	1	-	1	-	1	-
<b>F2</b>	CARRELLO SUPERIORE ESTERNO DESTRO VISTA INTERNA	VR10200D	1	-	1	-	1	-	1
<b>G</b>	BATTUTA CARRELLO SUPERIORE NYLON	VR10300	1	1	1	1	1	1	1
<b>H1</b>	CARRELLO SUPERIORE CENTRALE SINISTRO ZAMA	VR10700G	1	1	-	1	-	1	-
<b>H2</b>	CARRELLO SUPERIORE CENTRALE DESTRO ZAMA	VR10600D	1	-	1	-	1	-	1
<b>SCORRIMENTO INFERIORE</b>									
<b>I1</b>	SLITTA INFERIORE TERMINALE SINISTRA VISTA INTERNA	VR10400G	1	1	-	1	-	1	-
<b>I2</b>	SLITTA INFERIORE TERMINALE DESTRA VISTA INTERNA	VR10500D	1	-	1	-	1	-	1
<b>J1</b>	SLITTA INFERIORE CENTRALE SINISTRA VISTA INTERNA	VR10800G	1	1	-	1	-	1	-
<b>J2</b>	SLITTA INFERIORE CENTRALE DESTRA VISTA INTERNA	VR10801D	1	-	1	-	1	-	1
<b>COLLEGAMENTO PROFILI/ANTE</b>									
<b>K1</b>	POMELLA PER TELAIO DESTRA VISTA INTERNA	VR10821G	1	2	-	3	-	4	-
<b>K2</b>	POMELLA PER TELAIO SINISTRA VISTA INTERNA	VR10822D	1	-	2	-	3	-	4
<b>L1</b>	POMELLA CENTRALE PIATTA SINISTRA	VR10809G	1	2	2	4	2	6	2
<b>L2</b>	POMELLA CENTRALE PIATTA DESTRA	VR10810D	1	2	2	2	4	2	6
<b>M</b>	2 SET DI 2 MEZZE POMELLE CARRELLO CENTRALE + VITI	VR10828	1	1	1	1	1	1	1
<b>N1</b>	POMELLA CENTRALE DI MEZZO SINISTRA + PERNO AMOVIBILE + RONDELLE	VR10816G	1	-	-	1	-	2	-
<b>N2</b>	POMELLA CENTRALE DI MEZZO DESTRA + PERNO AMOVIBILE + RONDELLE	VR10817D	1	-	-	-	1	-	2
<b>O</b>	2 MEZZE POMELLE TERMINALI + VITI	VR10818	1	1	1	1	1	1	1
<b>CHIUSURA</b>									
<b>P</b>	KIT CHIAVISTELLO PIATTO + GUIDA ASTA NYLON NERO	VR10835	10	4	4	4	4	4	4
<b>Q</b>	GUIDA ASTA + MANIGLIETTA ERGONOMICA NYLON NERO	VR10837	10	-	-	4	4	4	4
<b>R</b>	ASTA ALLUMINIO 1,10M PER CHIAVISTELLO PIATTO	VR10838J	10	4	4	4	4	2	2
<b>S</b>	ASTA ALLUMINIO 2M PER CHIAVISTELLO PIATTO	VR10839J	10	-	-	-	-	2	2

# INFORMAZIONI

## Attrezzi Necessari

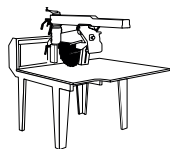

Sega circolare

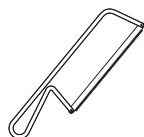

Seghetto per metallo

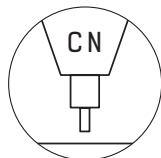

Lima

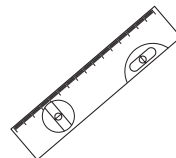

Livella

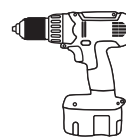

Trapano / Avvitatore



Punta per metallo

Ø13 mm  
Ø10 mm  
Ø7 mm  
Ø4,5 mm



Cacciavite

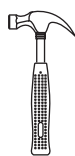

Martello

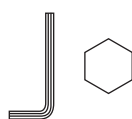

Chiave a brugola 2,5 e 8



Chiave a brugola T20 e T25



Chiave combinata 14



Frenafilotti

## Caratteristiche tecniche

Larghezza massima : 500 mm

Altezza massima : 3 000 mm

Sbordo su facciata : 500 mm maxi.

Peso fino a 20kg / anta

Spessore : da 30 a 35 mm

## Consigli

TORBEL declinerà ogni responsabilità se verranno montati componenti non previsti e non appartenenti a questa gamma. È compito del fabbricante assicurarsi che i componenti siano compatibili con le persiane. Il sistema dovrà essere posato da un professionista a regola d'arte rispettando tutte le NTC. Escludere la posa in prima linea costiera e nelle zone più ventose (Norma EN1991-1-4).

Rispettare le dimensioni massime per anta (3 m x 0,5 m x uno spessore compreso tra 30 e 35 mm) per un peso massimo di 20 kg per anta. Per il corretto funzionamento verificare che la struttura delle ante sia sufficientemente rigida e solida. Fissare saldamente il telaio (su una struttura sufficientemente resistente alle sollecitazioni del sistema) nei differenti singoli punti (i singoli punti si trovano a livello delle pomelle, delle battute inferiori e dei carrelli anta aperti e chiusi...) con la viteria adatta al sistema e al materiale della facciata. Utilizzare un fissaggio in ogni foro delle pomelle e dei chiavistelli previsti con la viteria adatta (vite per legno TF Ø5 o rivetto Ø4,8) in base al tipo di anta.

Prevedere delle aperture necessarie a far evacuare l'acqua soprattutto nella guida inferiore.

Il sistema si dovrà aprire e chiudere senza particolare sforzo (nessun attrito) e assicurarsi che non ci sia alcun ostacolo. Pulire e lubrificare regolarmente le pomelle e le ruote dei carrelli e delle guide inferiori. Sostituire i pezzi che presentano delle anomalie (usure importanti, rotture).

Verificare regolarmente la viteria, stringere o sostituire al bisogno.

Gli utenti sono tenuti a chiudere le persiane in caso di assenza e/o di avviso di vento forte (allerta arancione). Assicurarsi che i chiavistelli automatici siano posizionati correttamente quando le persiane sono chiuse, altrimenti aggiustarle manualmente.

È compito del produttore fornire all'utilizzatore finale i consigli di utilizzo e di pulizia dei nostri prodotti.

**Altezza Anta = Altezza telaio - 87 mm**

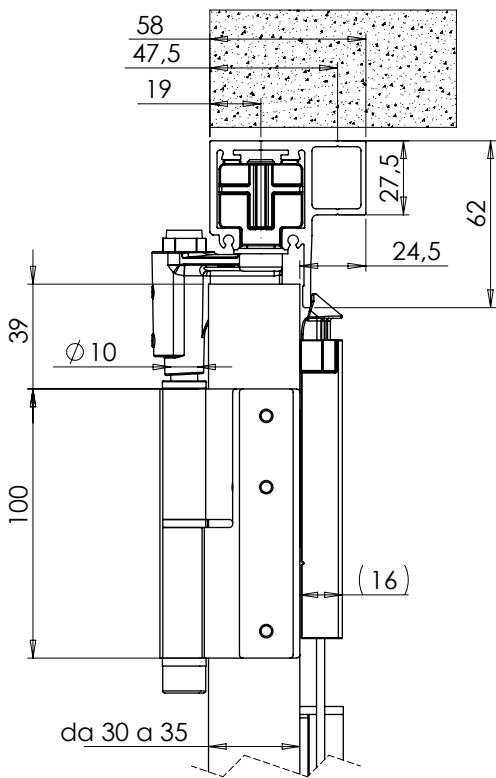

Lato esterno

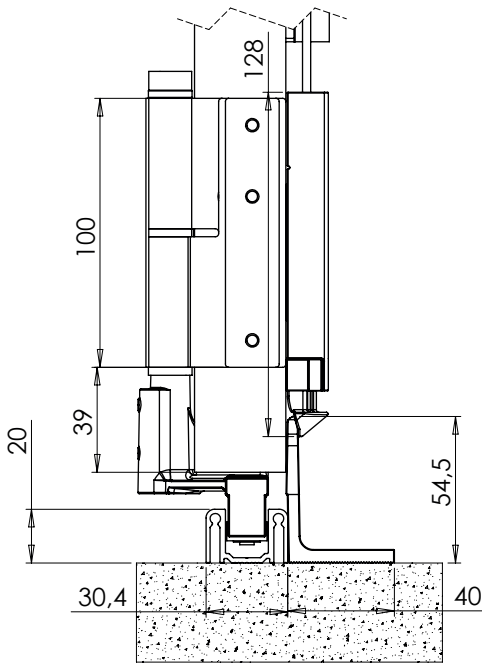

Lato interno

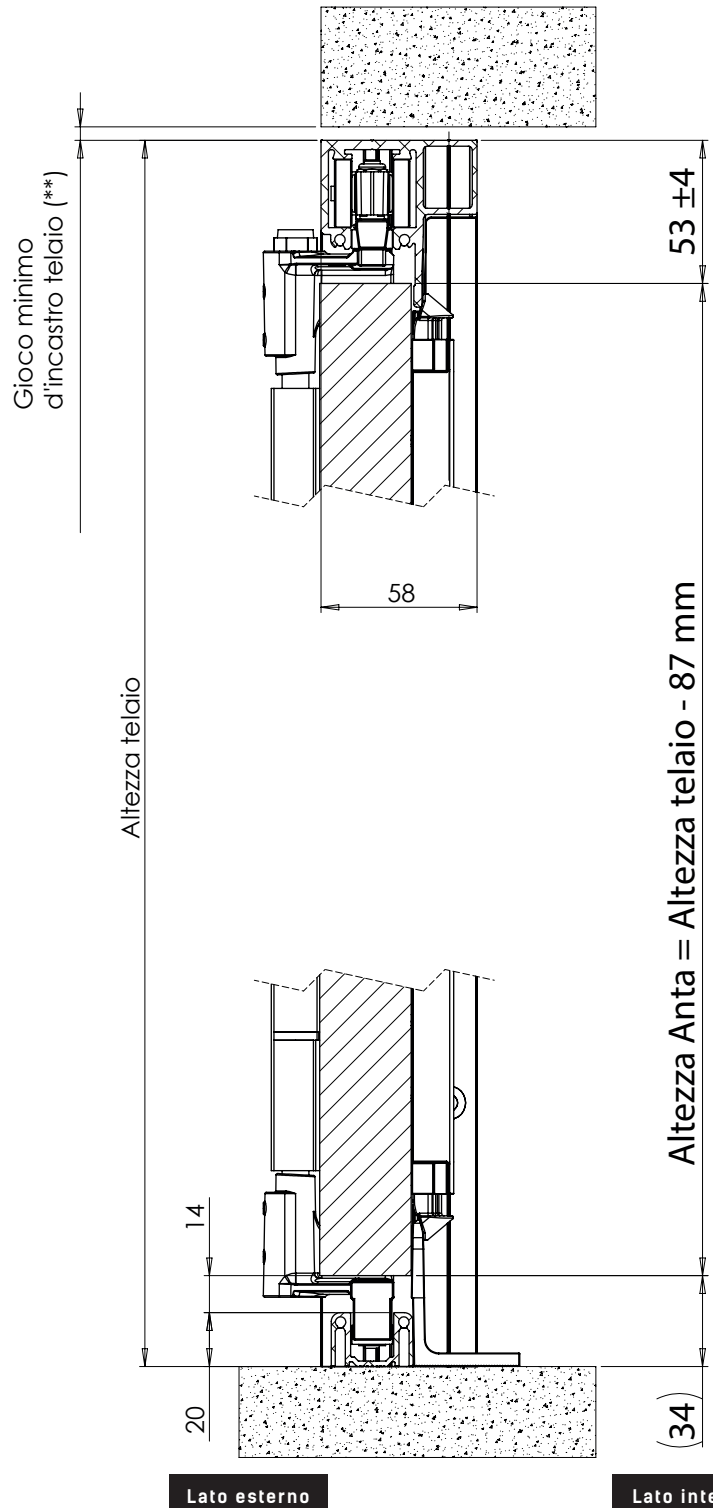

Gioco minimo d'incastro (\*\*)

Altezza telaio

Altezza Anta = Altezza telaio - 87 mm

(\*\*) Sulle aperture di dimensioni minime suggeriamo un gioco minimo di incastro periferico del telaio di 5 mm

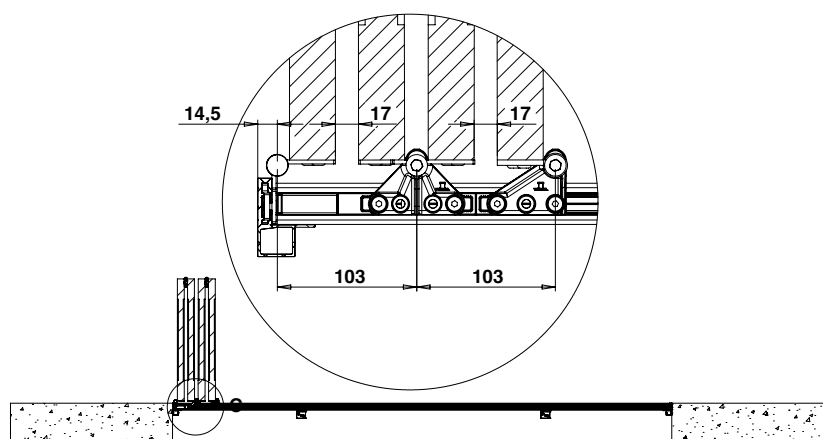

INTERNO

Larghezza anta =  
 $(L - J^{(*)} - 57 \text{ mm}) / 4$

LATO ESTERNO



LATO INTERNO

Gioco minimo  
di incastro telaio (\*\*)

Gioco minimo  
di incastro telaio (\*\*)

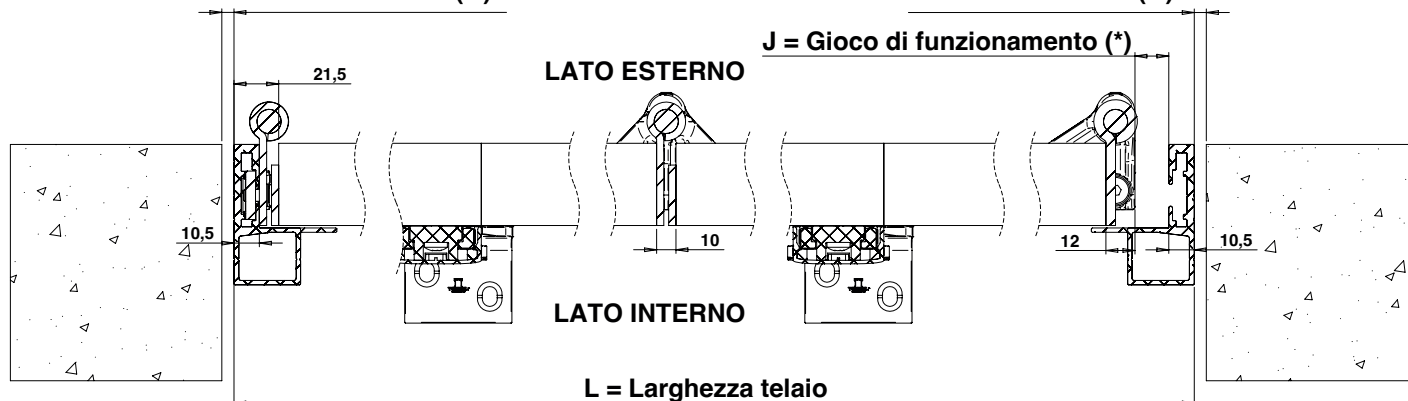

(\*) Il gioco di funzionamento J deve integrare l'arretramento del carrello durante la chiusura, le tolleranze dimensionali delle ante e del telaio nonché le dilatazioni legate alle variazioni igrometriche e termiche.

(\*) Arretramento del carrello: Larghezza anta 500 mm => 5 mm, 400 mm => 6.5 mm, 300 mm => 8.5 mm, 200 mm => 13 mm.

(\*\*) Sulle aperture di dimensioni minime suggeriamo un gioco minimo di incastro periferico del telaio di 5 mm.

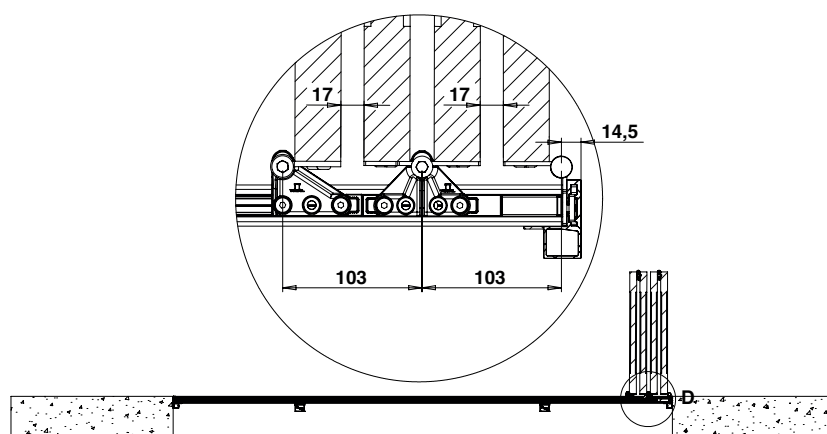

INTERNO

Larghezza anta =  
 $(L - J^n) - 57 \text{ mm} / 4$



Gioco minimo  
 di incastro telaio (\*\*)

J = Gioco di funzionamento (\*)

Gioco minimo  
 di incastro telaio (\*\*)

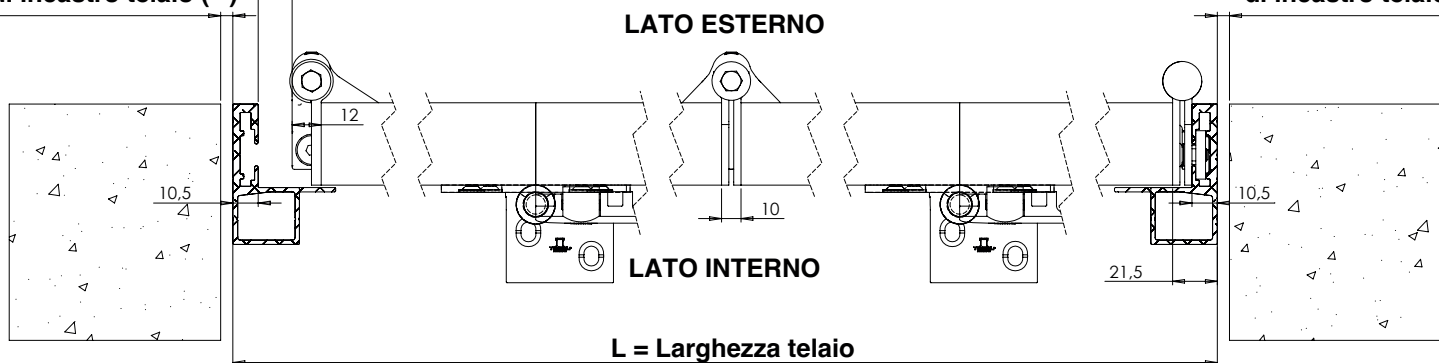

(\*) Il gioco di funzionamento J deve integrare l'arretramento del carrello durante la chiusura, le tolleranze dimensionali delle ante e del telaio nonché le dilatazioni legate alle variazioni igrometriche e termiche.

(\*) Arretramento del carrello: Larghezza anta 500 mm => 5 mm, 400 mm => 6.5 mm, 300 mm => 8.5 mm, 200 mm => 13 mm.

(\*\*) Sulle aperture di dimensioni minime suggeriamo un gioco minimo di incastro periferico del telaio di 5 mm.

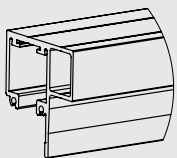
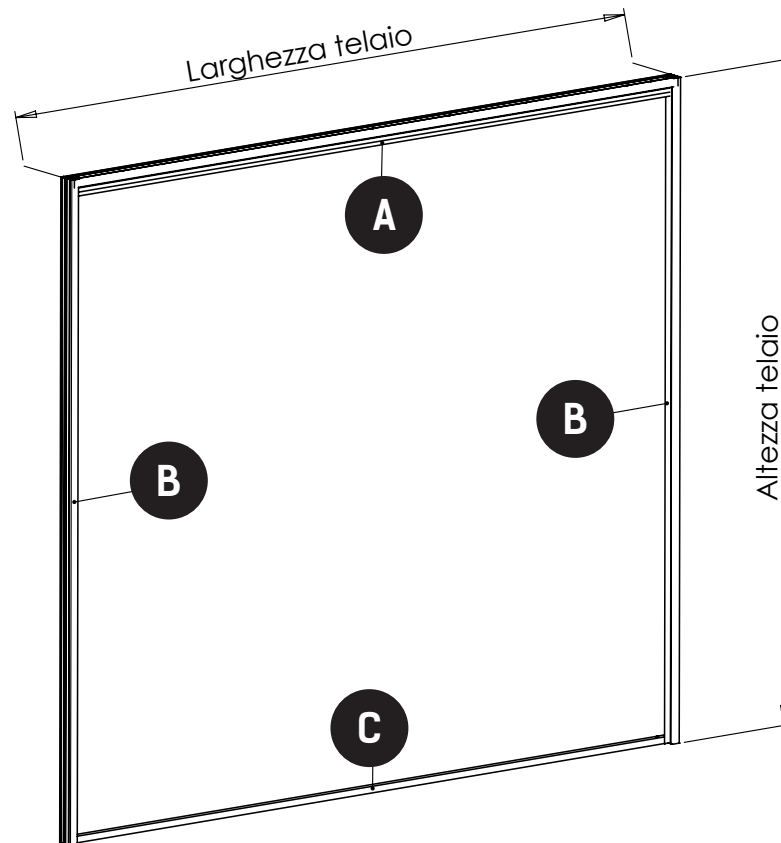
**A** VR10906

Lunghezza binario superiore =  
Larghezza del telaio - 21 mm

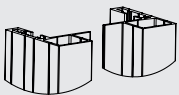
**B** VR10917

Lunghezza profilo telaio laterale =  
Altezza telaio

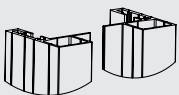
**B** VR10917

**OPZIONE senza lavorazione CNC**

Con piastre di giunzione

Lunghezza profilo telaio laterale =  
Altezza telaio - 62 mm

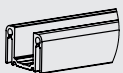
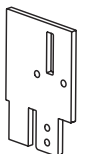
**C** VR10926

Lunghezza guida inferiore =  
Larghezza del telaio - 21 mm

# 2

## Foratura e lavorazione dei profili

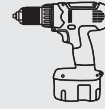

I punti di fissaggio devono essere a livello dei singoli punti.

### 2.1

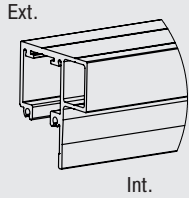

**A** VR10906

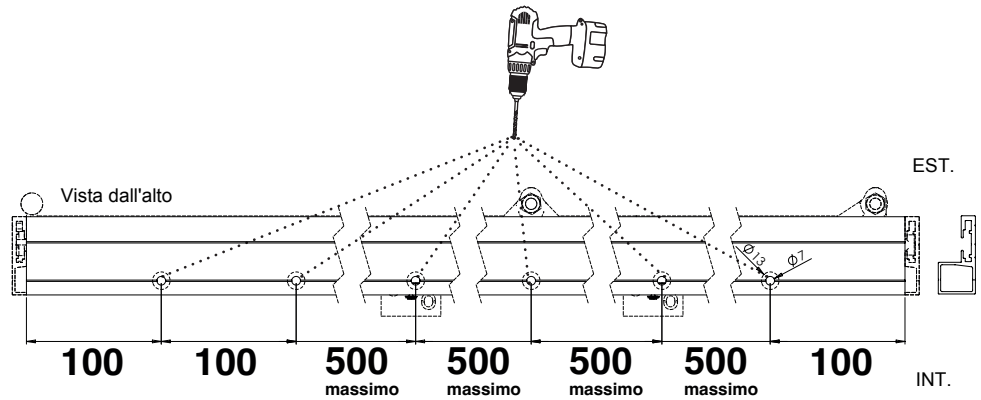

### 2.2

Prima della lavorazione

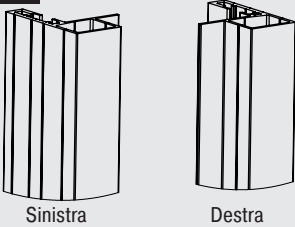

Sinistra

Destra

Dopo della lavorazione

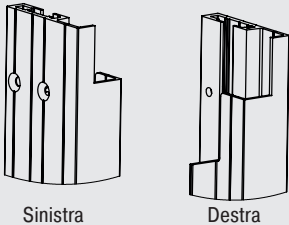

Sinistra

Destra

**B** VR10917

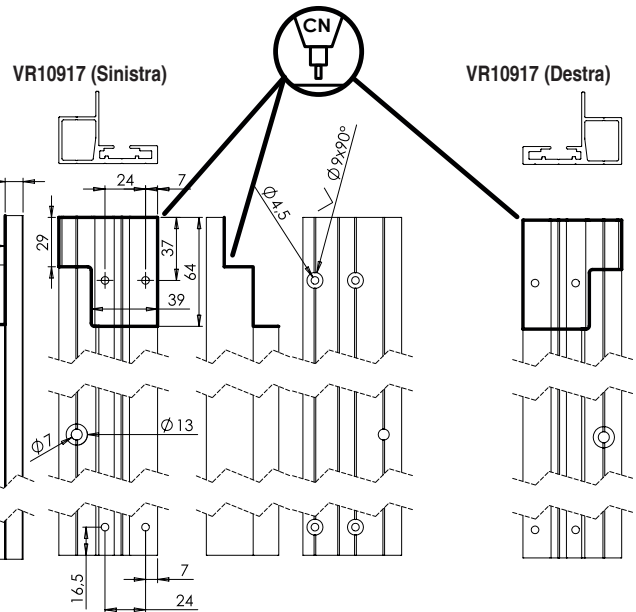
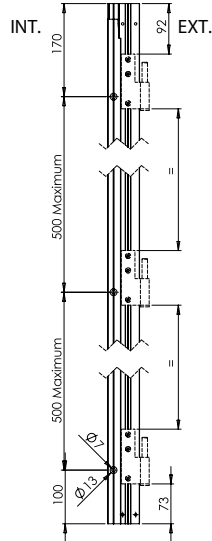

### 0

**OPZIONE senza lavorazione CNC**

**Con piastre di giunzione**

VR10917 (Sinistra)

VR10917 (Destra)

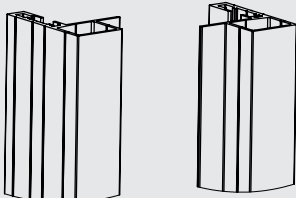
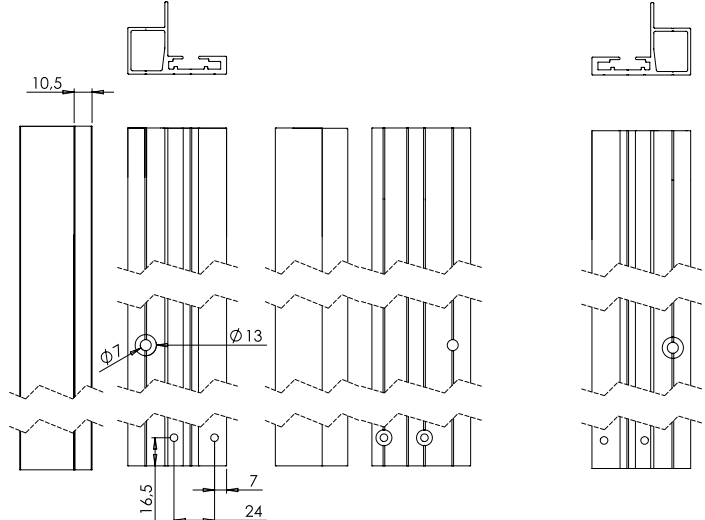

**B** VR10917



**OPZIONE senza lavorazione CNC**

**T** VR10918

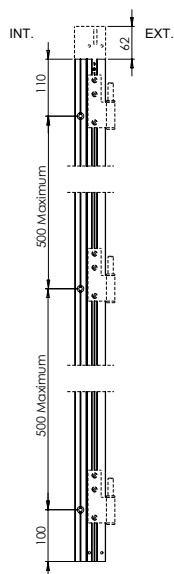

# 2

## Foratura e lavorazione dei profili

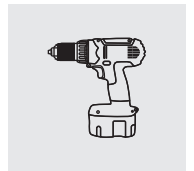

I punti di fissaggio devono essere a livello dei singoli punti.

### 2.3

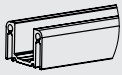

VR10926

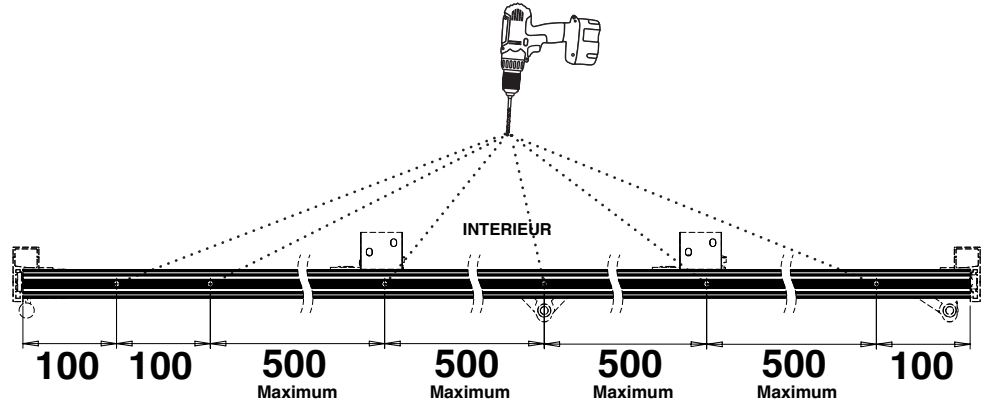

### Drenaggio del binario di guida inferiore

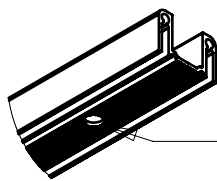
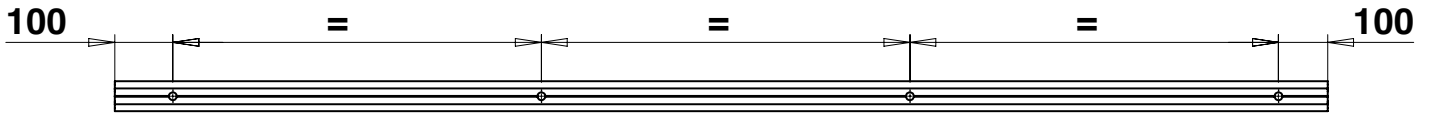
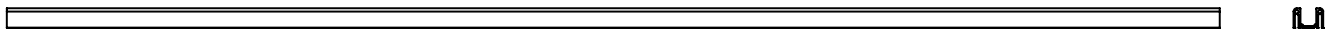

Drenaggio verticale Ø8

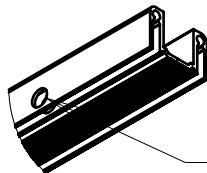

Drenaggio orizzontale Ø8 (orientato verso l'esterno)

# 3 Montaggio del telaio

Configurazione  
**4+0**  
EST.  
INT.

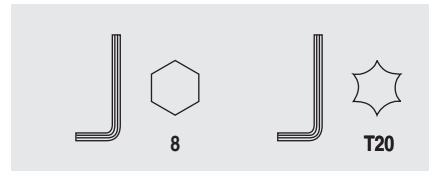

Per facilitare il montaggio e permettere la posa a terra del telaio, i passaggi qui di seguito sono orientati con vista dall'esterno.

## 3.1



F1 VR10100G

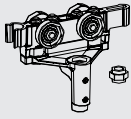

H1 VR10700G

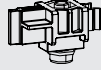

G VR10300

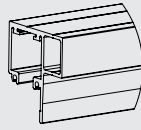

A VR10906

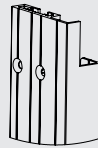

B VR10917

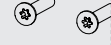

E VR10830

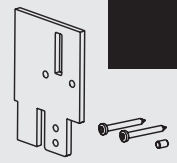

T VR10918

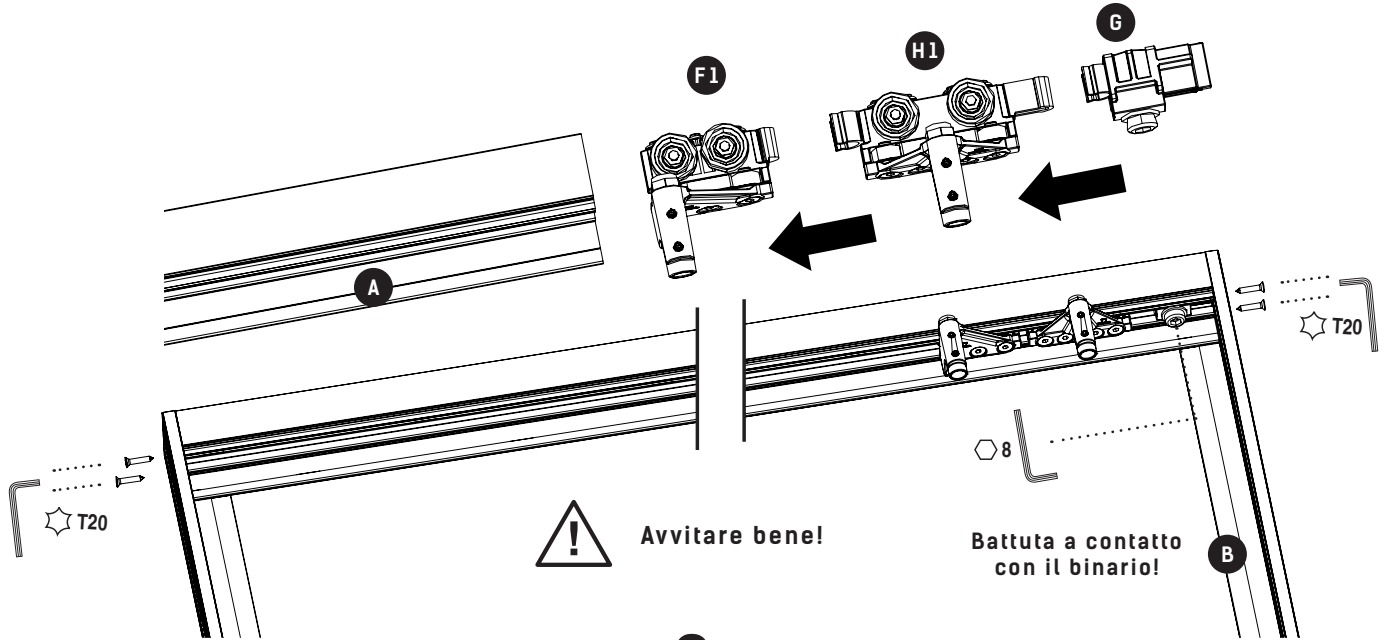

0

**OPZIONE senza lavorazione CNC**

**Con piastre di giunzione**

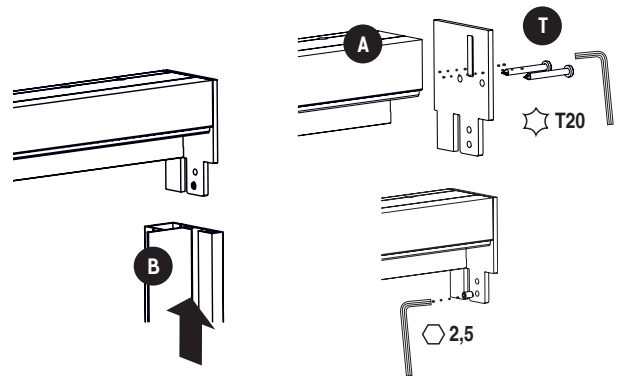
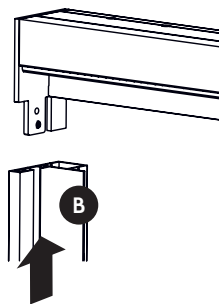
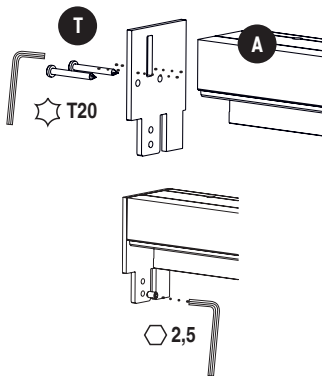

## 3.2

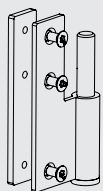

K1 VR10821G

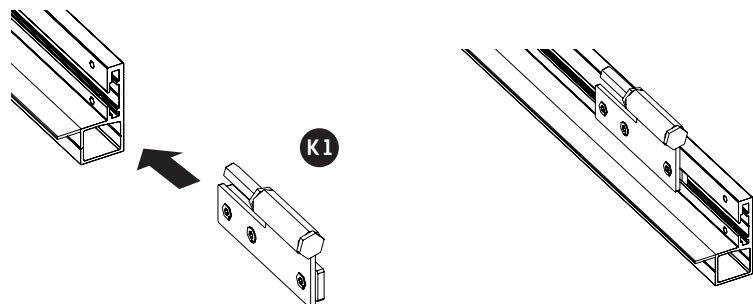

# 3 Montaggio del telaio

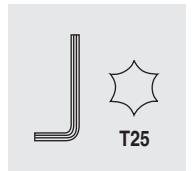

Per facilitare il montaggio e permettere la posa a terra del telaio, i passaggi qui di seguito sono orientati con vista dall'esterno.

## 3.3

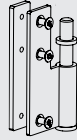

**K1** VR10821G

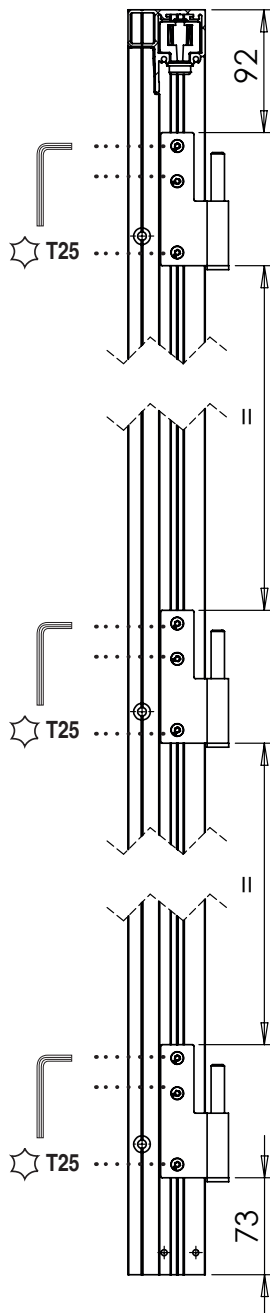

H		
< 1800 mm	1800 mm <....> 2800 mm	> 2800 mm

# 3 Montaggio del telaio

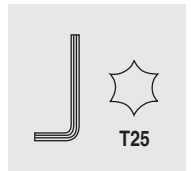

Per facilitare il montaggio e permettere la posa a terra del telaio, i passaggi qui di seguito sono orientati con vista dall'esterno.

## 3.4

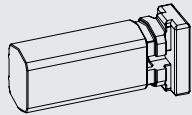

**E** VR10830

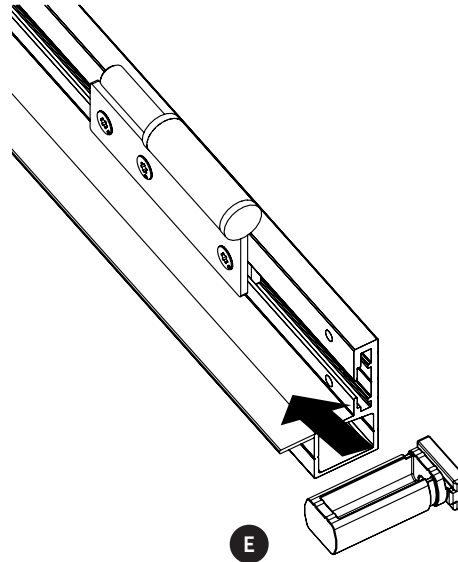

Attenzione al senso di posa della battuta!

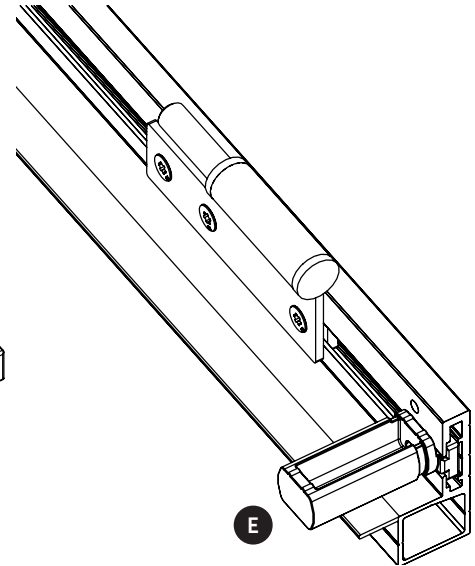

## 3.5

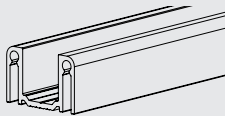

**C** VR10926

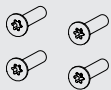

**E** VR10830

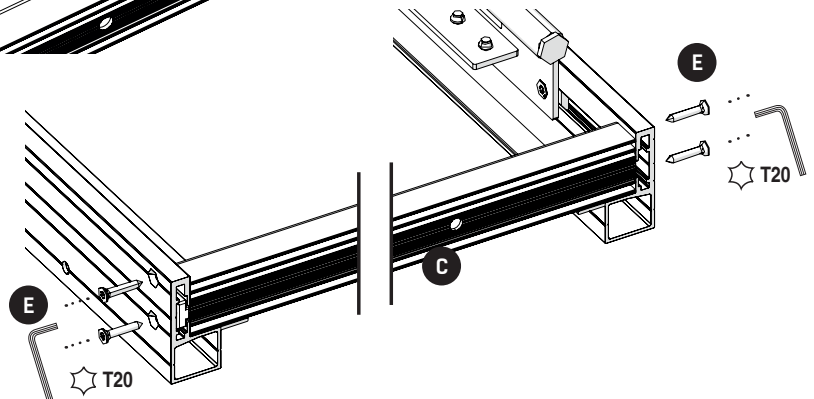
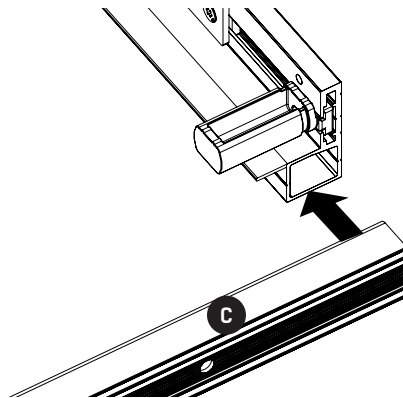

Primo paio di ante

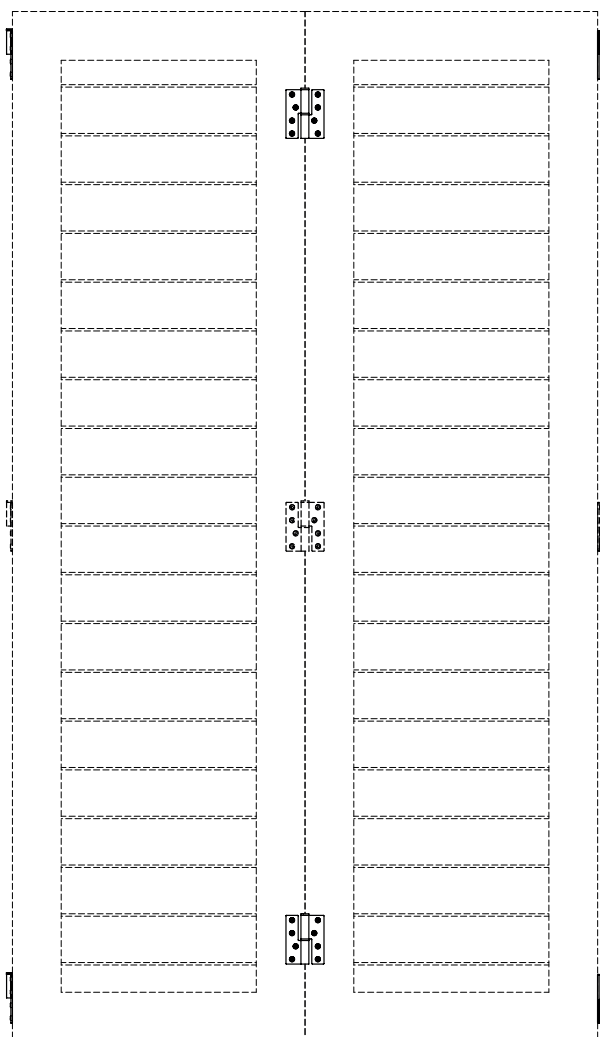

Secondo paio di ante

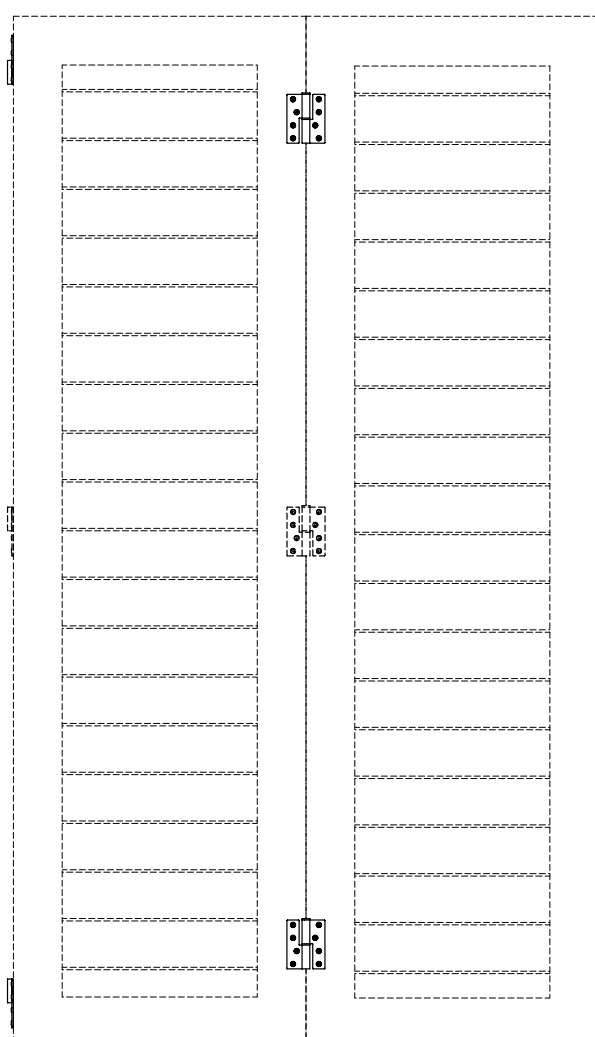

H

&lt; 1800 mm

1800 mm &lt;....&gt; 2800 mm

&gt; 2800 mm

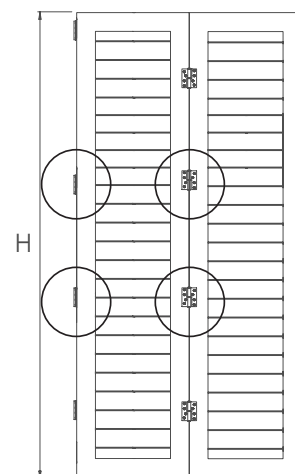
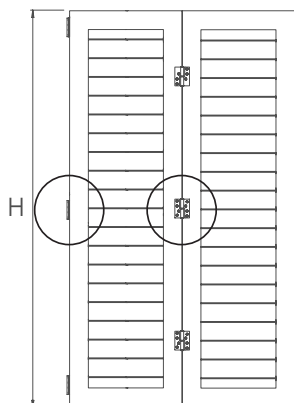
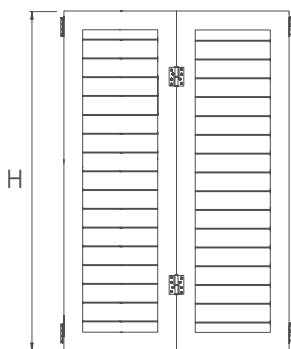

## 4.1

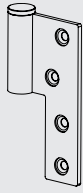

K1 VR10821G

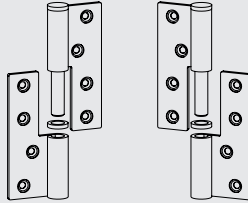

L1 VR10809G

L2 VR10810D

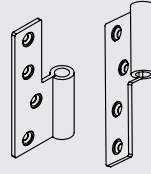

M VR10828

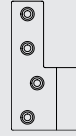
Opzionale  
se H > 1800 mm

N1 VR10816G

Vista dall'interno

Perno verso il basso!



L2

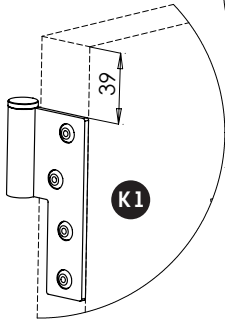

K1

160 mini

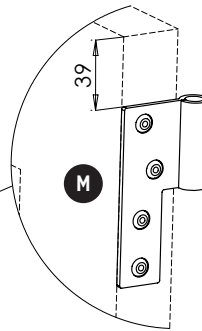

M

Perno verso il basso!



L1

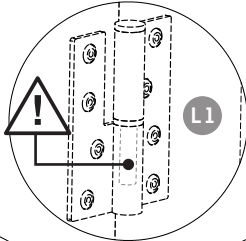

N1

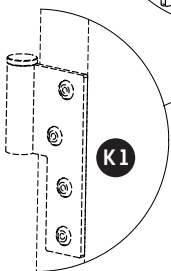
Attenzione alla posizione  
del chiavistello!  
P.22

K1

M

M

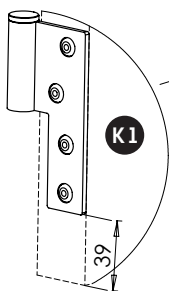

K1

160 mini

Perno verso il basso!

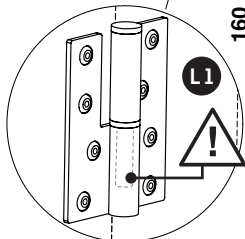

L1

Possibilità  
di montaggio  
del chiavistello  
in officina

P. 22

## 4.2

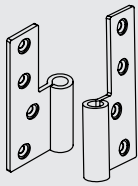

M VR10828

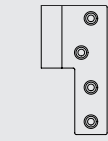
Opzionale  
se H > 1800 mm

N1 VR10816G

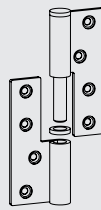

L1 VR10809G

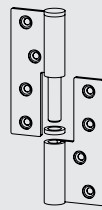

L2 VR10810D

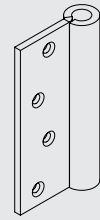

O VR10818

Vista dall'interno

Perno verso il basso!

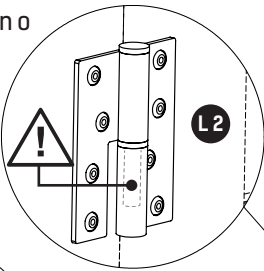

L2

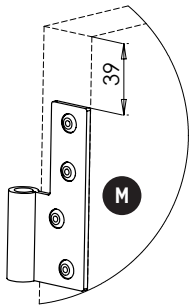

M

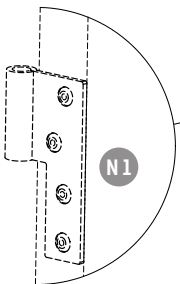

N1

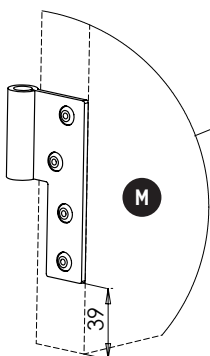

M

Perno verso il basso!

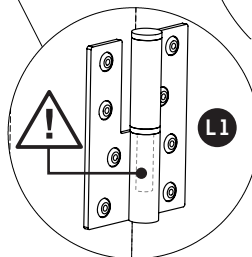

L1

160 mini

160 mini

Attenzione alla posizione  
del chiavistello!  
P.22

Perno verso il basso!

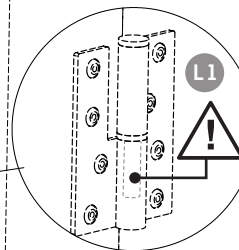

L1

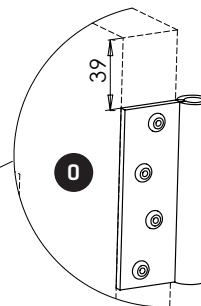

O

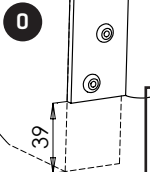

O

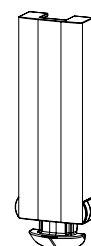
Possibilità  
di montaggio  
del chiavistello  
in officina

P.22

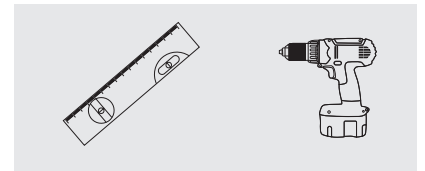

## 5 Installazione del telaio (regolazione geometrie e calibrzione)

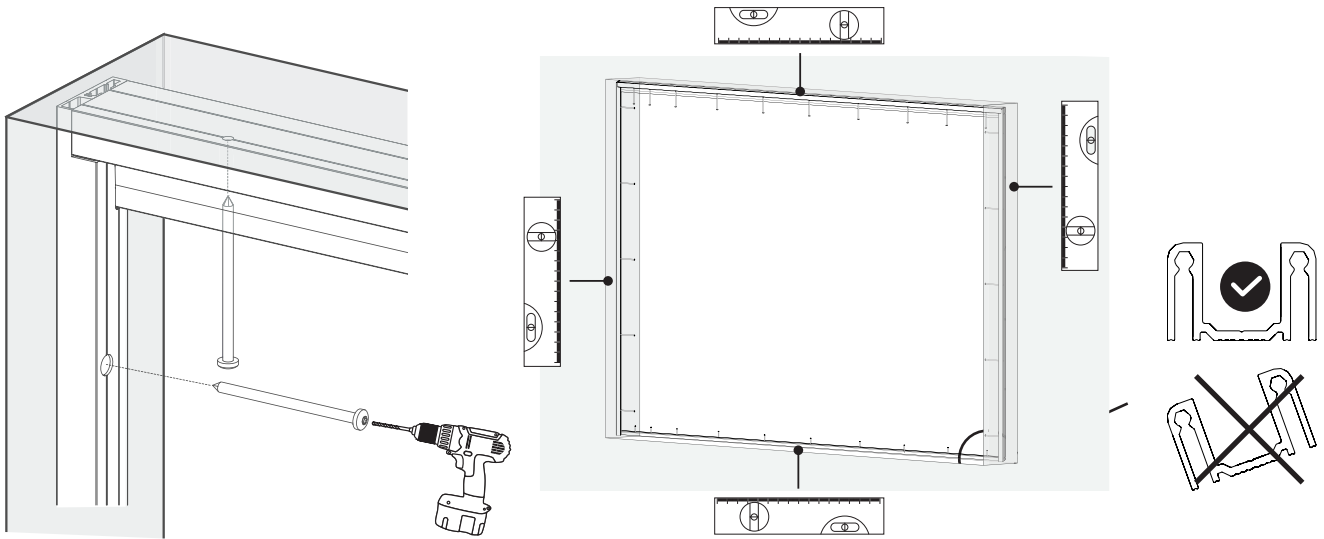

## 6 Montaggio delle ante

Vista dall'interno

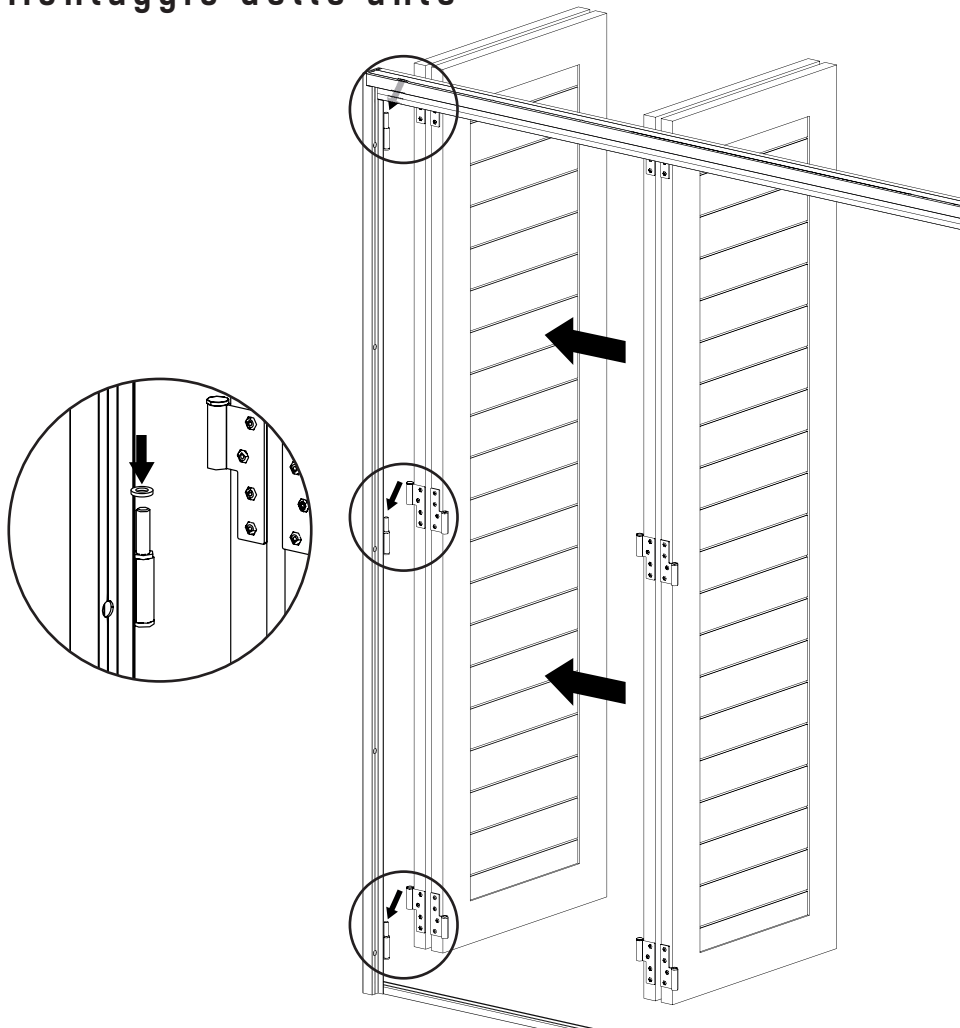

7



**M** VR10828

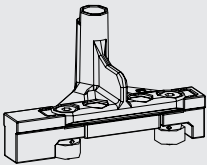

**J1** VR10800G

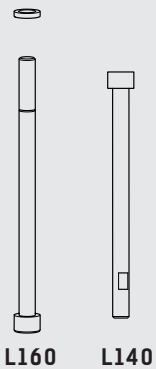

**O** VR10818

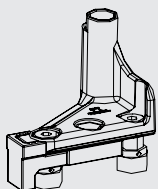

**I1** VR10400G

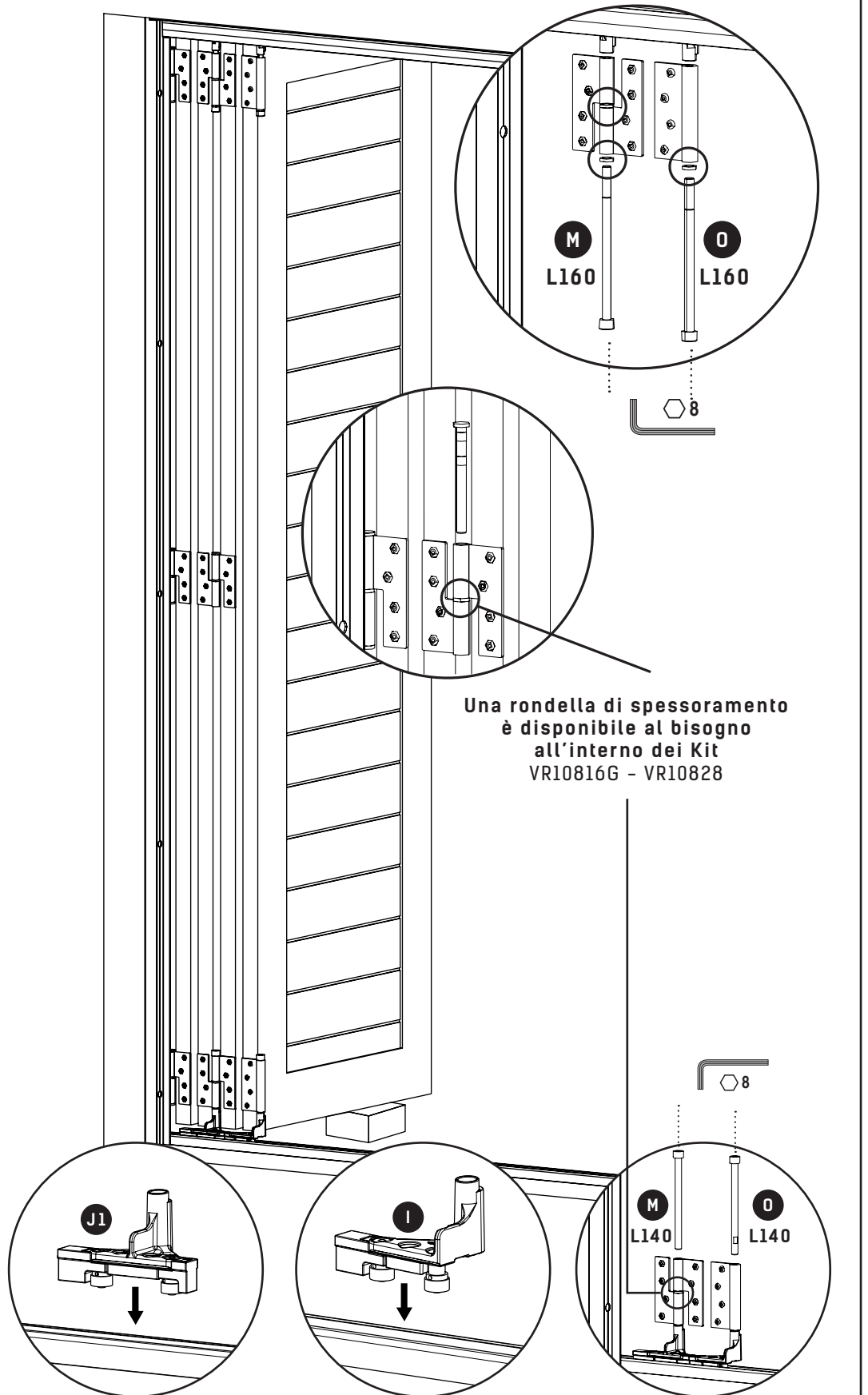

## 8.1

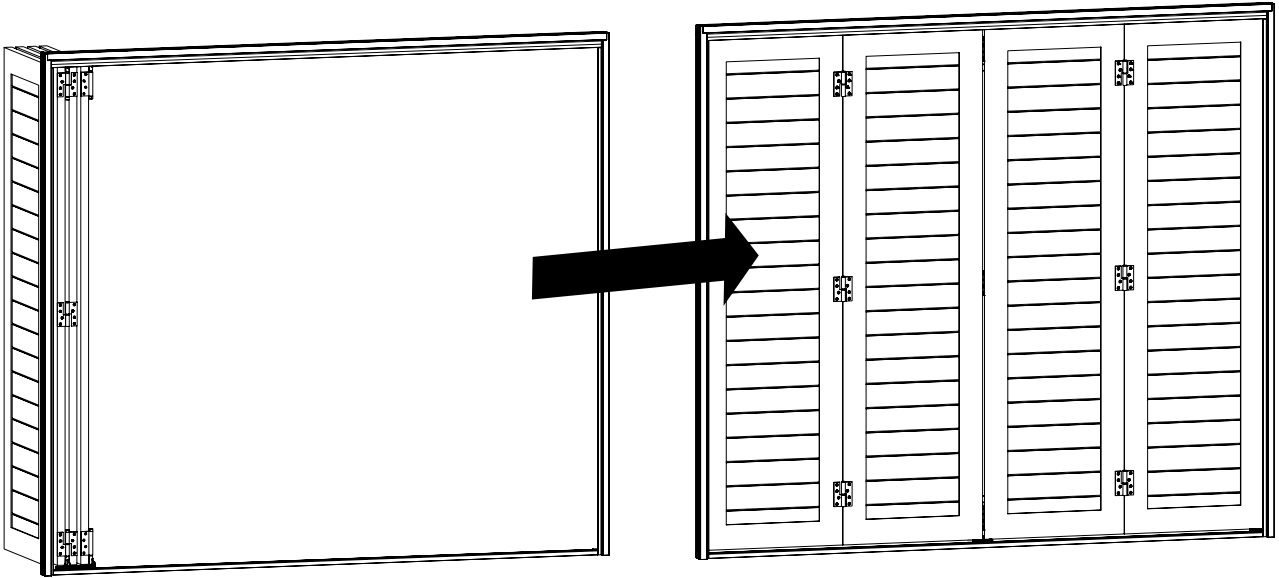

## 8.2



Verificare che la parte alta dello sbordo della ruota sia dentro il binario di 5mm per garantire una presa ottimale.

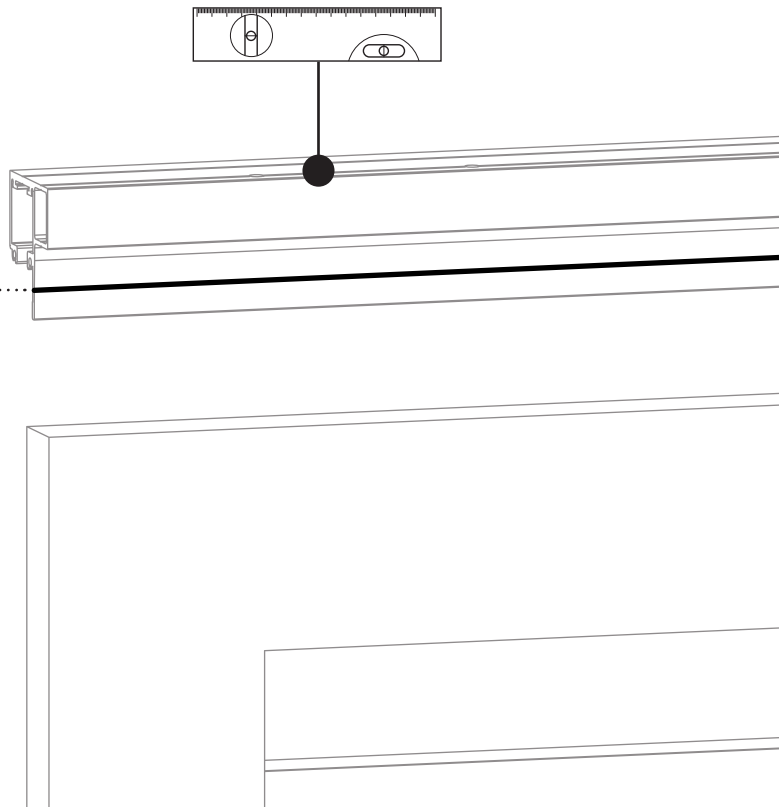

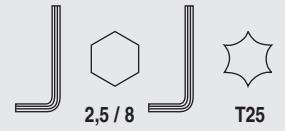

## 8.3

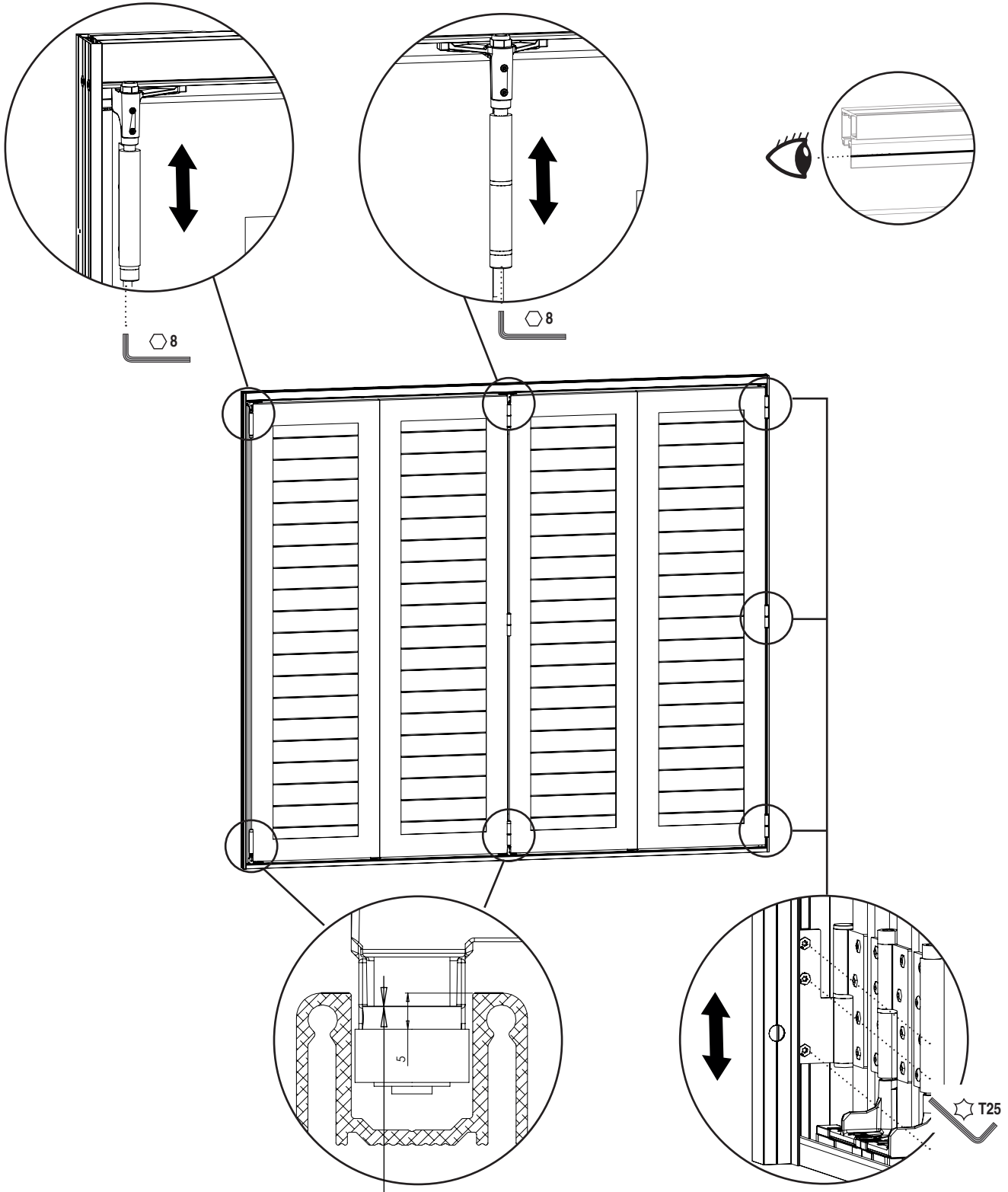

Verificare che la parte alta dello sbordo della ruota sia dentro il binario di 5mm per garantire una presa ottimale.

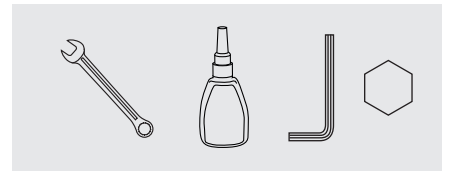

**8.4**

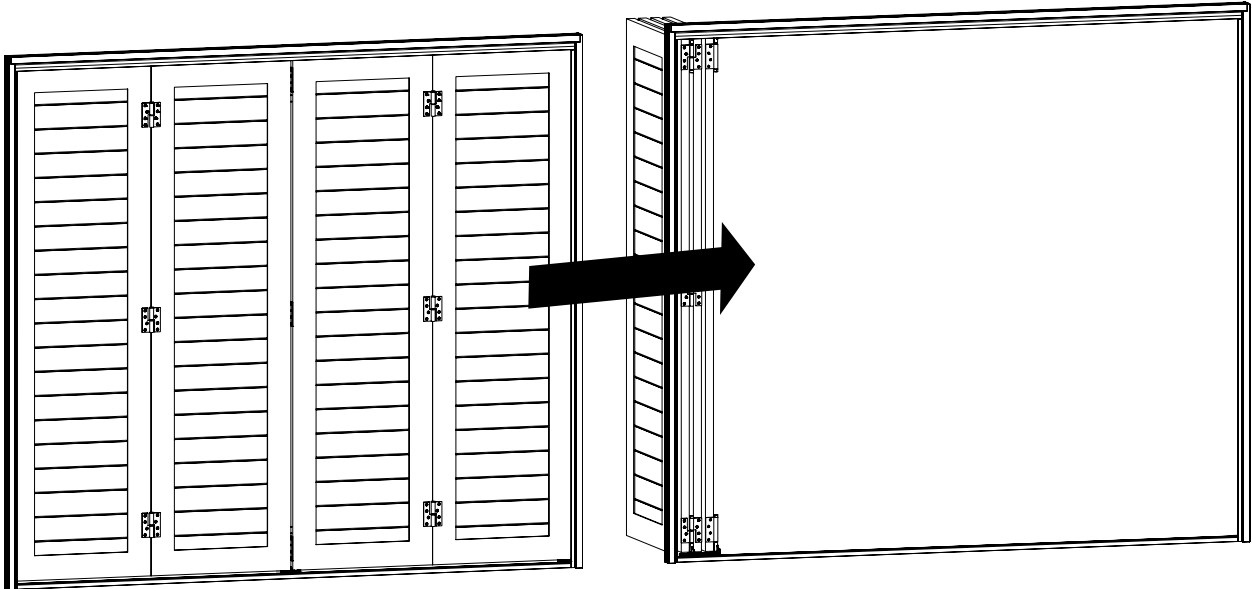

**Fissaggio di sicurezza**

Frenafiletto

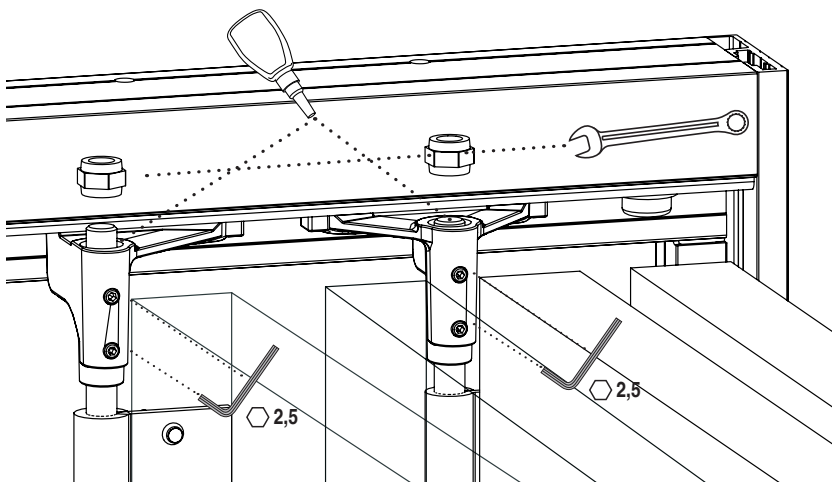

Frenafiletto

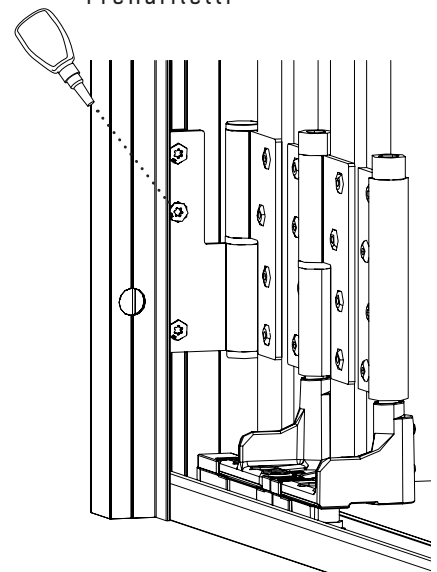

9.1

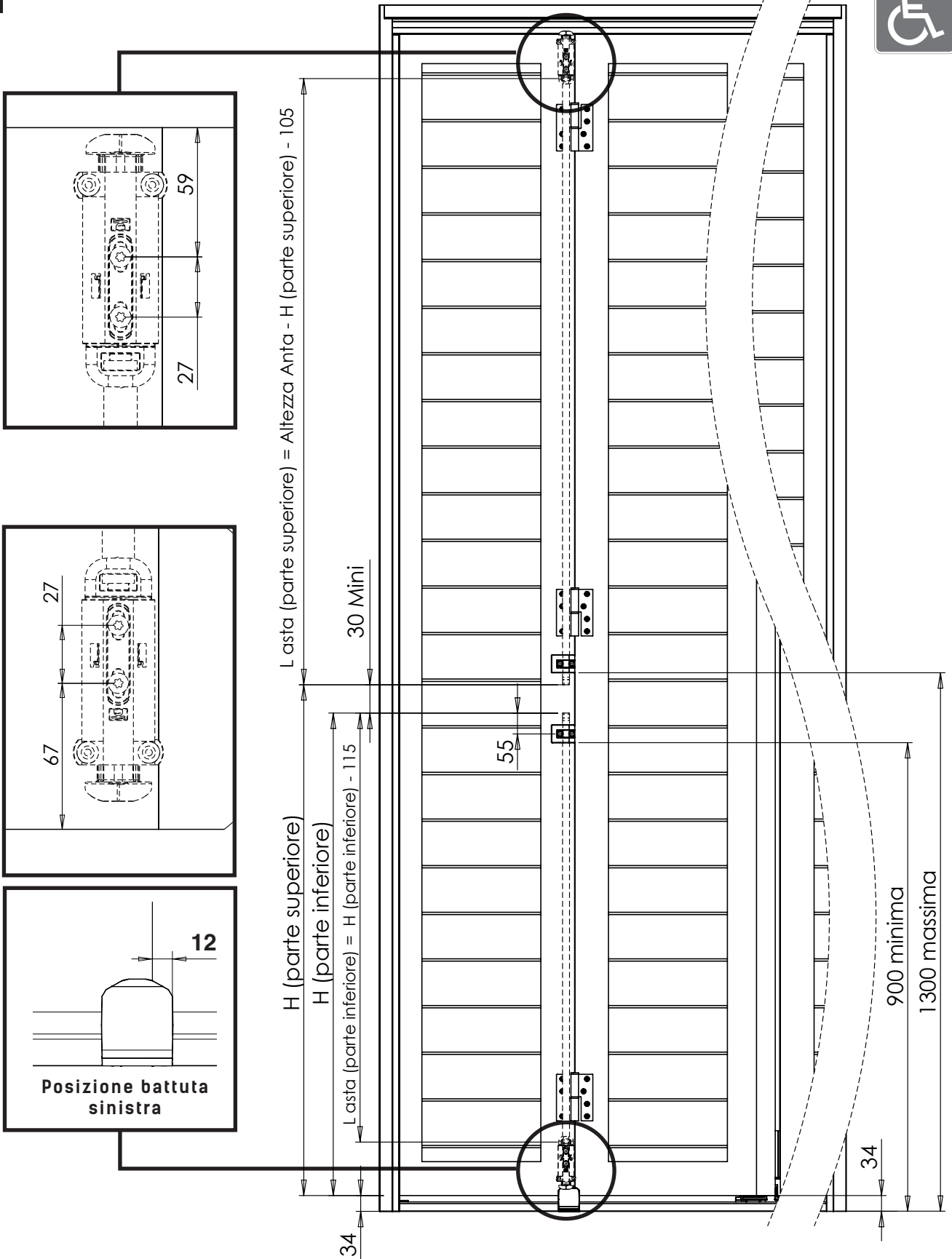

# 9

## Montaggio del chiavistello e della battuta

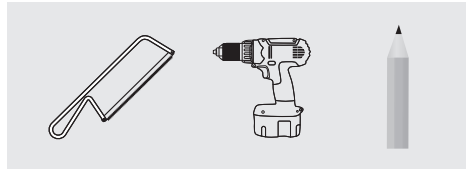

### 9.2

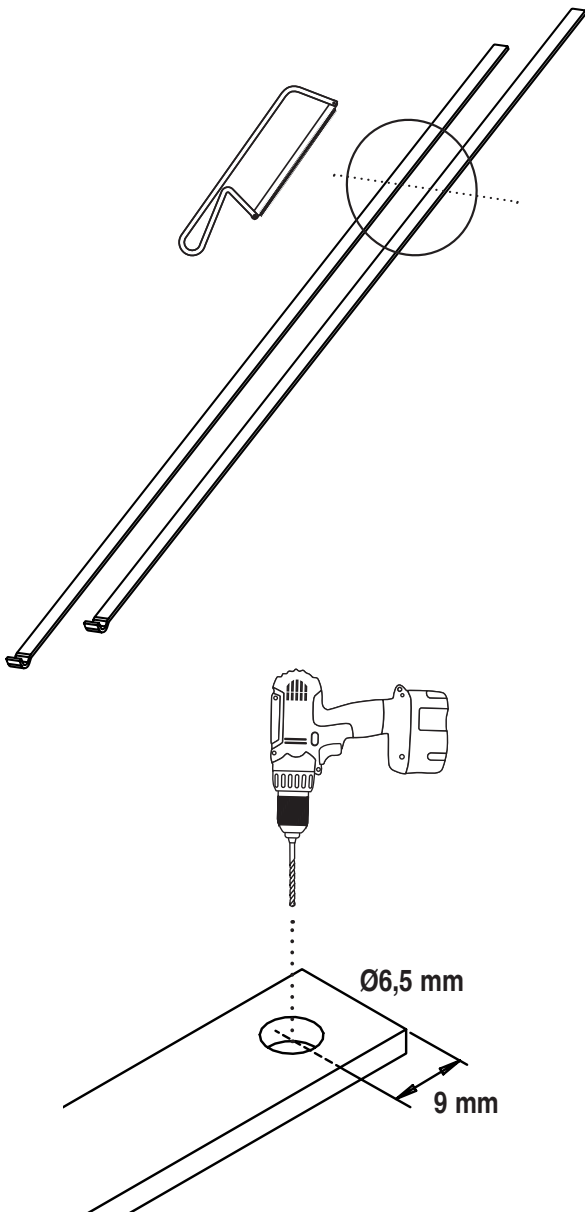
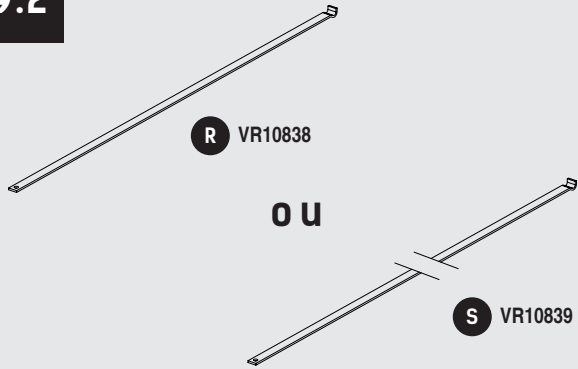

### 9.3

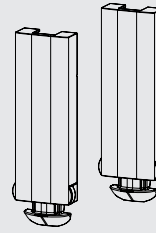

P VR10835

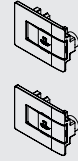

Q VR10837

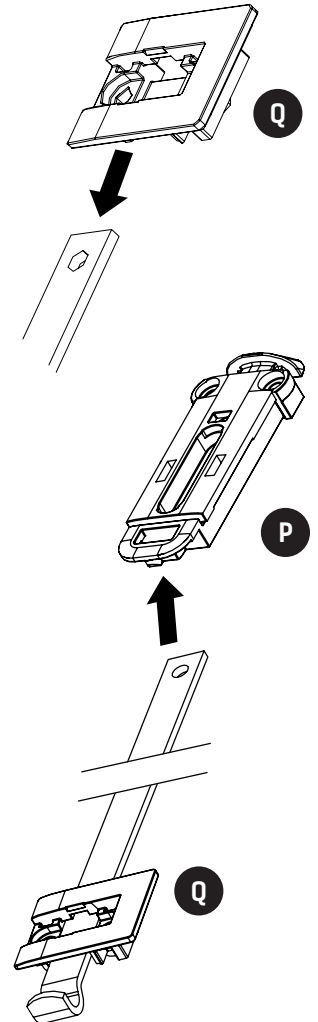
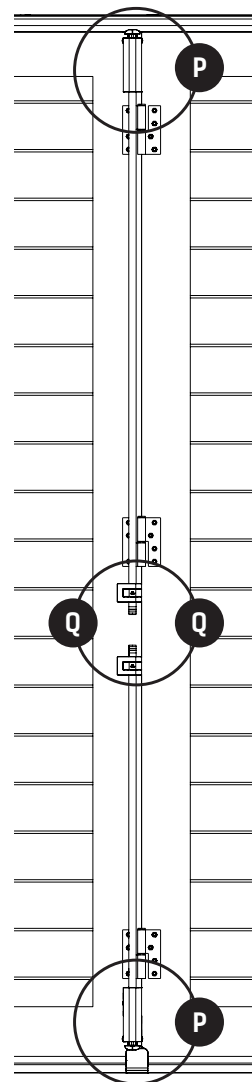

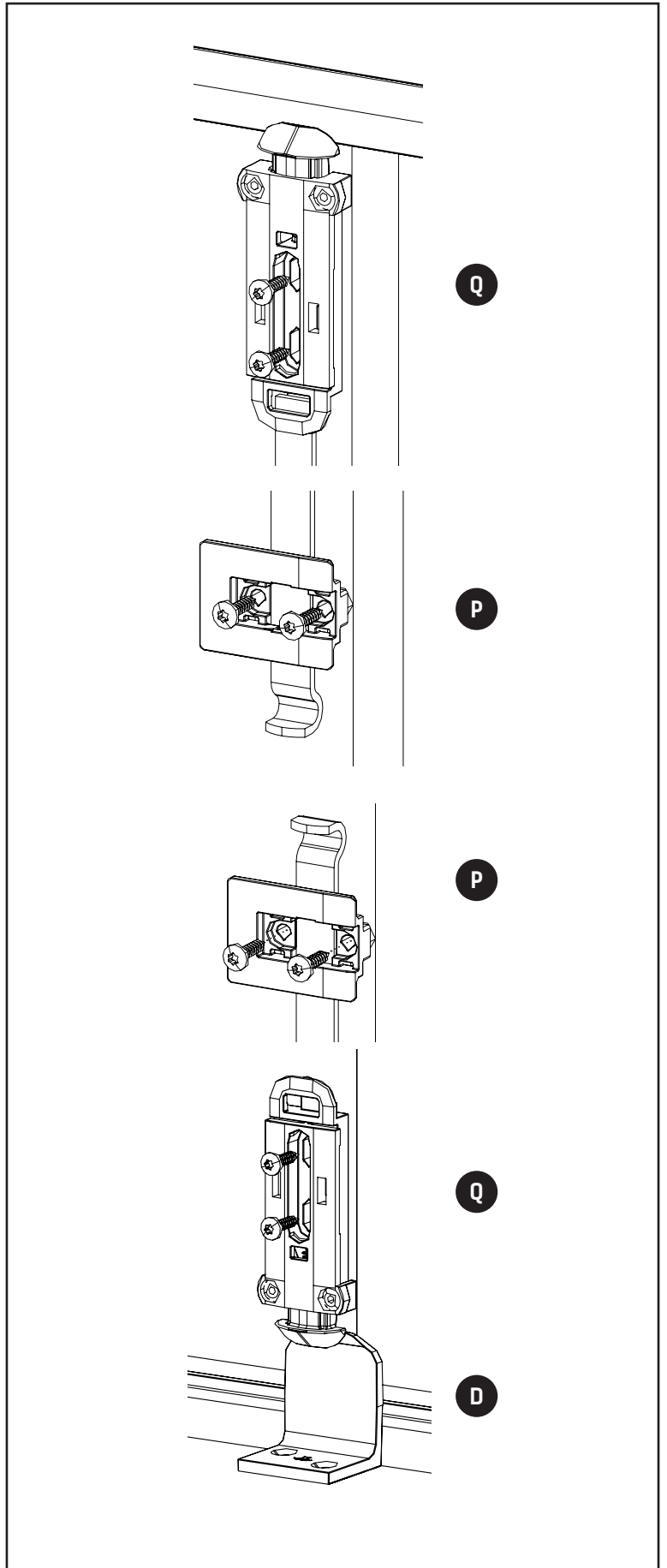
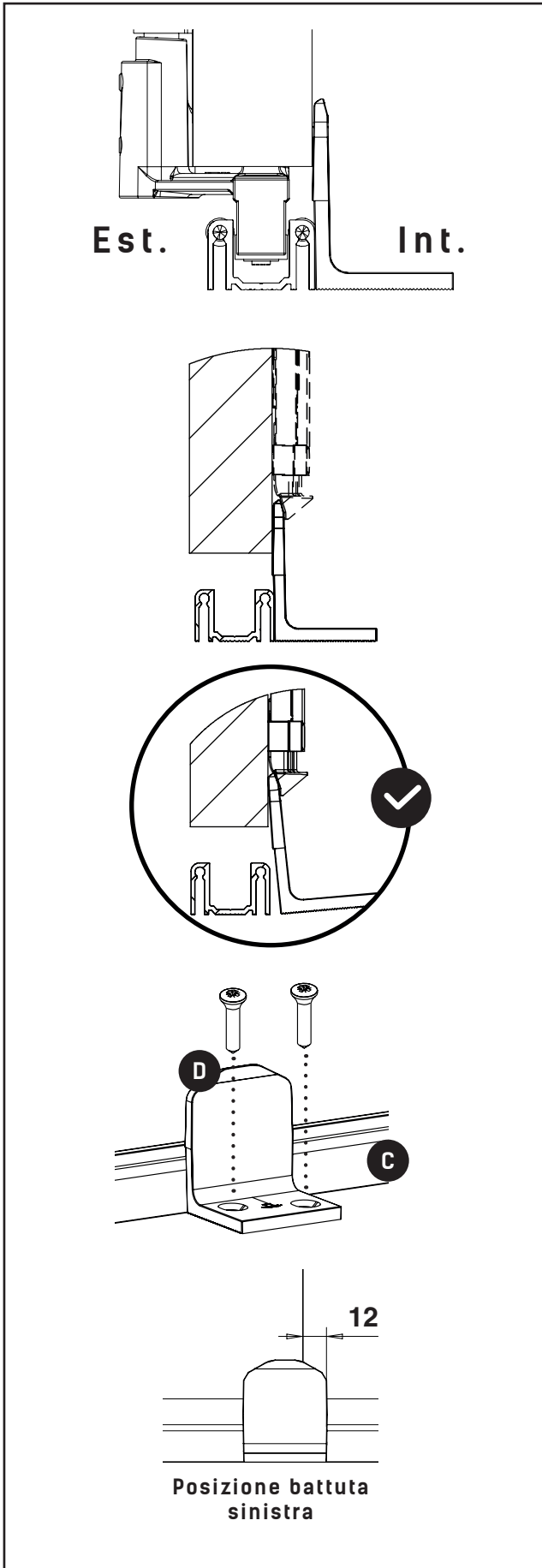
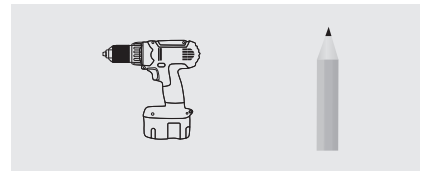

# 9

## Montaggio del chiavistello e della battuta

Configurazione  
**4 + 0**  
EST.  
INT.

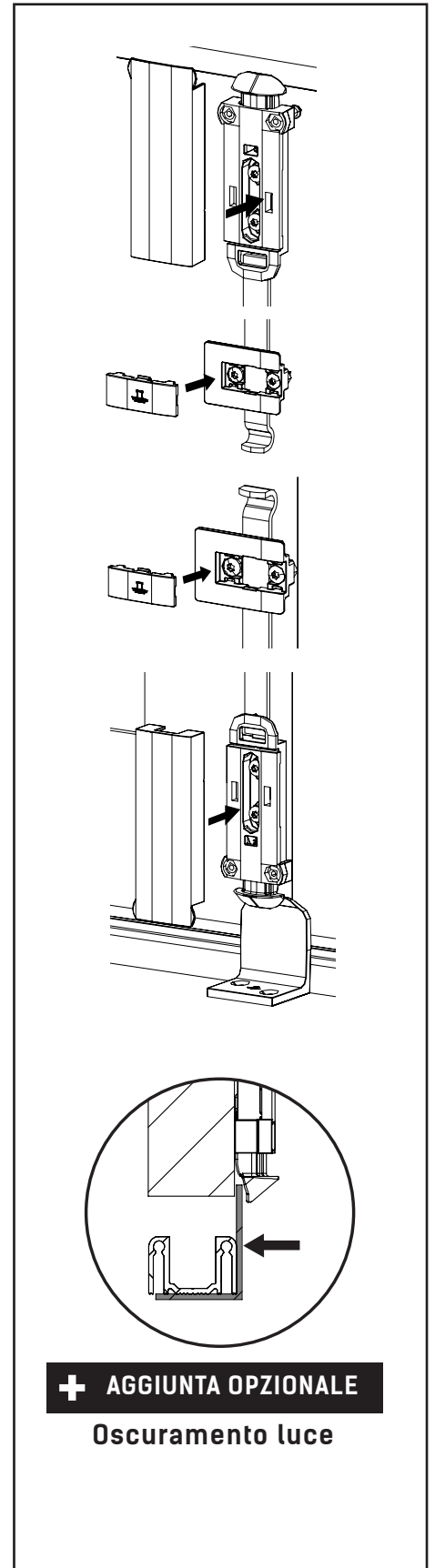
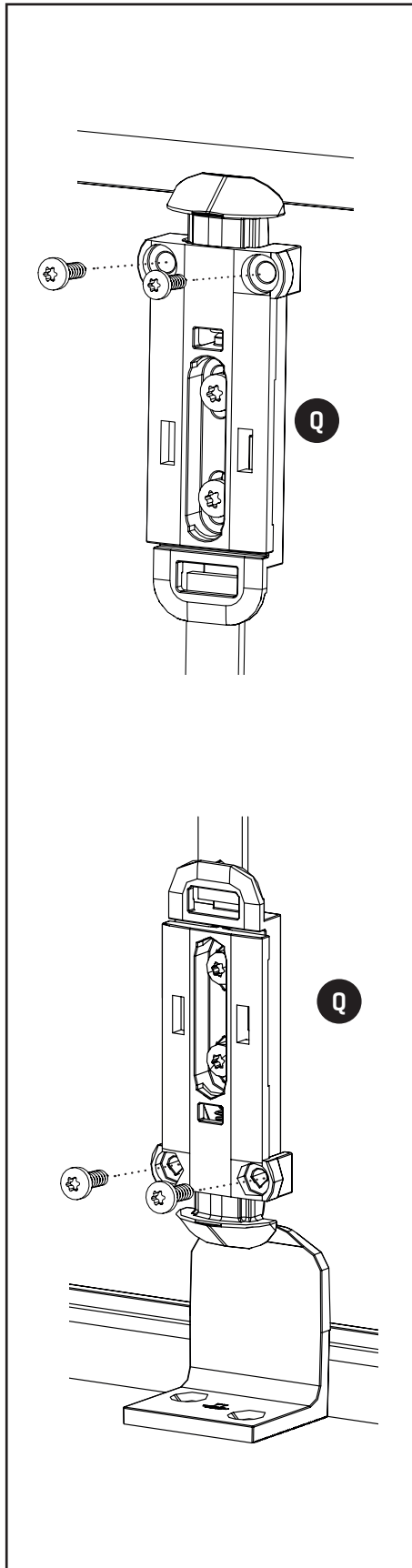
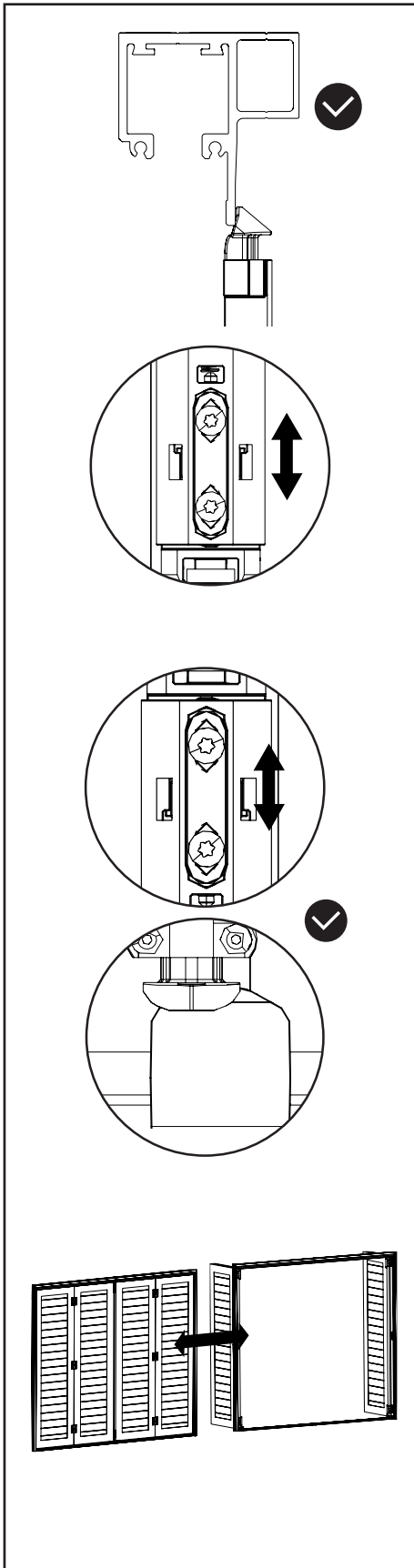
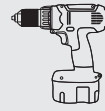

**+ AGGIUNTA OPZIONALE**  
Oscuramento luce

**✓ L'installazione è completata !**







**TORBEL® SRL**

Via Brandizzo, 121/G - 10088 Volpiano (TO)  
Tel : +39 011 995 56 12 - info@torbel.it - www.torbel.it

